

OVERALL LANDSCAPE PLAN - PHASE I  
SCALE: 1" = 50'

PLANT SCHEDULE - INFILL PLANTING			
TREES	CODE	QTY	BOTANICAL NAME / COMMON NAME
	CE	25	Conocarpus erectus / Green Buttonwood * 12' ht. x 5' spr., single straight trunk, full head, 3" cal. measured 4.5' above grade, Florida #1, container
	CS	6	Conocarpus erectus sericeus / Silver Button Wood * 12' ht. x 5' spr., single straight trunk, full head, 3" cal. measured 4.5' above grade, Florida #1, container
	PE3	3	Pychosperma elegans / Alexander Palm B&B, triple headed palm, min. 10', 12', 14' clear wood, 7-8" cal.
	RE	2	Roystonea elata / Florida Royal Palm* 14' gray wood, 5' spr., single straight trunk, matched, Florida #1, B&B
	SQ	5	Syagrus romanzoffiana / Queen Palm Field Grown, 10' Gray wood, Full dense head
	VM2	2	Veitchia montgomeryana / Montgomery Palm FG, 12' GW, 18' OA HT, Single Straight Trunk 10" CAL, Full Crown
SHRUBS	CODE	QTY	BOTANICAL NAME / COMMON NAME
	CHR	35	Chrysobalanus icaco 'Red Tip' / Red Tip Cocoplum * 3 gal, min., 24" ht. x 18" spr., 30" o.c., Full to base, full dense shrub
	CES	12	Conocarpus erectus / Silver Buttonwood * 3 gal, 30" ht. x 18" spr., full to base
SHRUB AREAS	CODE	QTY	BOTANICAL NAME / COMMON NAME
	CAR	108	Carissa macrocarpa 'Emerald Blanket' / Emerald Blanket Carissa * 3 Gal., 12" Ht. x 16" Spr., 24" O.C., Full
	GIF	34	Ficus microcarpa 'Green Island' / Green Island Ficus 3 gal. min., 16" ht., 16" spr., full, 24" o.c.
	ILE	8	Ilex vomitoria 'Stokes Dwarf' / Dwarf Yaupon * 3 Gal., 12" Ht. x 12" Spr., 18" O.C., Full dense shrub
	JAS	130	Jasminum multiflorum / Downey Jasmine * 3 gal., 18" ht. x 12" spr., full, dense pot
	JAS2	519	Jasminum volubile / Wax Jasmine * 3 GAL, 16" HT x 16" SPR, 24" O.C., Full dense shrub
	PIT	15	Pittosporum tobira 'Variegata' / Variegated Pittosporum * 3 gal., 18" ht. x 18" spr., full dense shrub

\* Denotes Town of Lake Park Preferred Plan List species

PLANT SCHEDULE - PHASE I			
TREES	CODE	QTY	BOTANICAL NAME / COMMON NAME
	CE	8	Conocarpus erectus / Green Buttonwood * 12' ht. x 5' spr., single straight trunk, full head, 3" cal. measured 4.5' above grade, Florida #1, container
	CS	9	Conocarpus erectus sericeus / Silver Button Wood * 12' ht. x 5' spr., single straight trunk, full head, 3" cal. measured 4.5' above grade, Florida #1, container
	PE2	3	Pychosperma elegans / Alexander Palm B&B, double headed palm, min. 14' and 18' of clear wood, 7-8" cal.
	PE3	4	Pychosperma elegans / Alexander Palm B&B, triple headed palm, min. 10', 12', 14' clear wood, 7-8" cal.
	RE	4	Roystonea elata / Florida Royal Palm* 14' gray wood, 5' spr., single straight trunk, matched, Florida #1, B&B
	SP	38	Sabal palmetto / Cabbage Palmetto* Varying heights in groups 12-16" c.w., hurricane cut
	VM2	6	Veitchia montgomeryana / Montgomery Palm FG, 12' GW, 18' OA HT, Single Straight Trunk 10" CAL, Full Crown
SHRUBS	CODE	QTY	BOTANICAL NAME / COMMON NAME
	CHR	162	Chrysobalanus icaco 'Red Tip' / Red Tip Cocoplum * 3 gal, min., 24" ht. x 18" spr., 30" o.c., Full to base, full dense shrub
	CES	38	Conocarpus erectus / Silver Buttonwood * 3 gal, 30" ht. x 18" spr., full to base
SHRUB AREAS	CODE	QTY	BOTANICAL NAME / COMMON NAME
	CAR	288	Carissa macrocarpa 'Emerald Blanket' / Emerald Blanket Carissa * 3 Gal., 12" Ht. x 16" Spr., 24" O.C., Full
	DUR	263	Duranta erecta 'Gold Mound' / Gold Mound Durlanta * 3 gal, 16" ht. x 16" spr., 24" o.c., Full dense shrub, fully rooted pot
	ILE	272	Ilex vomitoria 'Stokes Dwarf' / Dwarf Yaupon * 3 Gal., 12" Ht. x 12" Spr., 18" O.C., Full dense shrub
	JAS2	65	Jasminum volubile / Wax Jasmine * 3 GAL, 16" HT x 16" SPR, 24" O.C., Full dense shrub
	PIT	279	Pittosporum tobira 'Variegata' / Variegated Pittosporum * 3 gal., 18" ht. x 18" spr., full dense shrub
	TRA	52	Trachelospermum jasminoides / Star Jasmine Trellis 3 Gal., Trellis, Fully rooted pot, dense

\* Denotes Town of Lake Park Preferred Plan List species

Phase I - Landscape Area	
Total Landscape Area	71,945 SF
Total Sod Area	31,223 SF
Dry Retention Area (to be exempt from sod percentage)	9,172 SF
Sod percentage within total Landscape Area	30.7%

Phase III - Affected Area Landscape Area	
Total Landscape Area	16,406 SF
Total Sod Area	6,568 SF
Sod percentage within total Landscape Area	40.0%

Preferred Plant List Percentages	
Phase I & II Preferred Species Used	97.7%
Phase III Preferred Species Used	95.3%

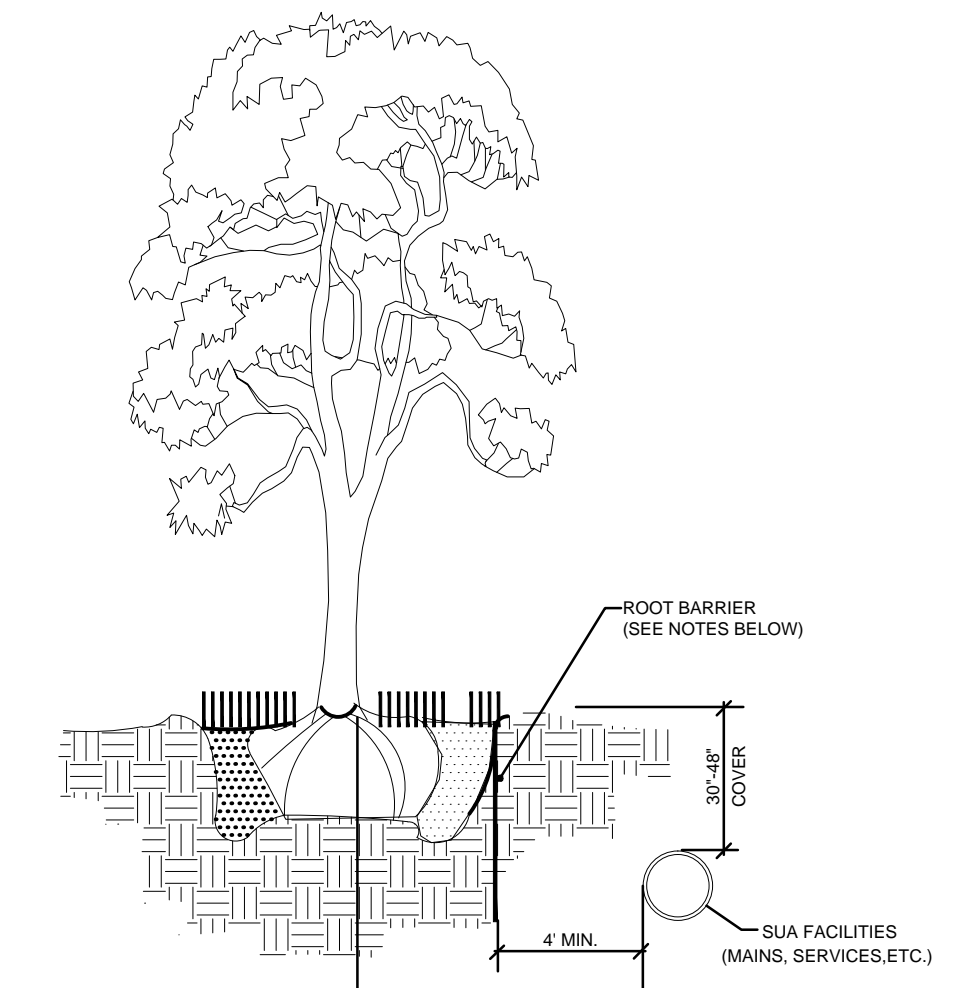

- NOTES: (PLEASE REFER TO WRITTEN SPECIFICATIONS FOR ADDITIONAL REQUIREMENTS)
- THIS DISTANCE SHALL BE 10' MINIMUM WITH ROOT BARRIER AND 15' MINIMUM IF NO ROOT BARRIER IS USED.
  - ALL ROOT BARRIERS SHALL BE 4' MINIMUM FROM ALL SEACOAST FACILITIES.
  - THE INSTALLATION OF ROOT BARRIERS SHALL BE COORDINATED WITH SEACOAST AND INSPECTED BY SEACOAST PRIOR TO BACKFILLING. ALL ROOT BARRIERS SHALL EXTEND UP TO FINISHED GRADE.
  - ROOT BARRIERS SHALL BE MINIMUM 36" DEEP. APPROVED PRODUCTS INCLUDE 'DEEP ROOT' AND 'ROOT SOLUTIONS'. FLEXIBLE BARRIERS SHALL BE 36" PANELS MANUFACTURED BY BIOBARRIER.
  - ALL ROOT BARRIERS SHALL BE INSTALLED IN ACCORDANCE WITH MANUFACTURERS WRITTEN INSTRUCTIONS.
  - LARGE PALM TREES INCLUDE ROYAL, WASHINGTONIAN, BISMARCK AND SIMILAR SIZED SPECIES.

Typical Canopy Tree, Large or Exotic  
Palm Tree with Root Barrier  
July 25, 2012

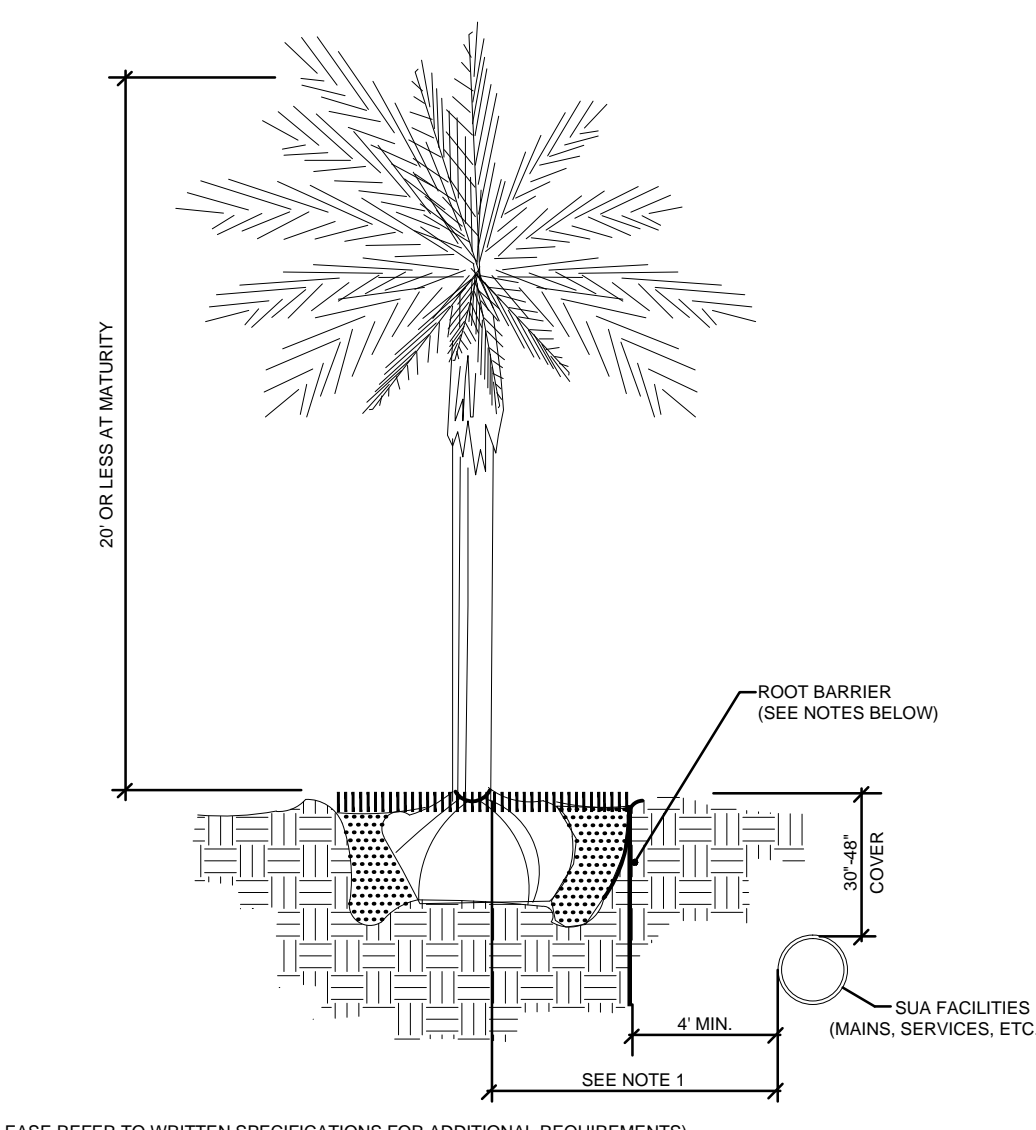

- NOTES: (PLEASE REFER TO WRITTEN SPECIFICATIONS FOR ADDITIONAL REQUIREMENTS)
- THIS DISTANCE SHALL BE 7' MINIMUM WITH ROOT BARRIER AND 10' MINIMUM IF NO ROOT BARRIER IS USED.
  - ALL ROOT BARRIERS SHALL BE 4' MINIMUM FROM ALL SEACOAST FACILITIES.
  - THE INSTALLATION OF ROOT BARRIERS SHALL BE COORDINATED WITH SEACOAST AND INSPECTED BY SEACOAST PRIOR TO BACKFILLING. ALL ROOT BARRIERS SHALL EXTEND UP TO FINISHED GRADE.
  - ROOT BARRIERS SHALL BE MINIMUM 36" DEEP. APPROVED PRODUCTS INCLUDE 'DEEP ROOT' AND 'ROOT SOLUTIONS'. FLEXIBLE BARRIERS SHALL BE 36" PANELS MANUFACTURED BY BIOBARRIER.
  - ALL ROOT BARRIERS SHALL BE INSTALLED IN ACCORDANCE WITH MANUFACTURERS WRITTEN INSTRUCTIONS.

Typical Small Tree or Palm Tree with Root Barrier  
July 25, 2012

**Urban design ki/day STUDIOS**  
Urban Planning & Design  
Landscape Architecture  
Communication Graphics

The Offices at City Place  
477 S. Rosemary Ave., Suite 225  
West Palm Beach, FL 33401  
561.366.1100 FAX 561.366.1111  
www.udkstudios.com  
#LCC000035

Copyright:  
All ideas, designs, arrangements, and plans represented by this drawing are owned by and the property of the designer, and were created for the exclusive use of the specified project. These ideas, designs, arrangements or plans shall not be used by, or disclosed to any person, firm, or corporation without the written permission of the designer.

**Earl Stewart Toyota**  
Lake Park, FL  
Overall Landscape Plan - Phase I

Drawing name: H:\00000000\Earl Stewart Toyota\_03-002-004\Overall Landscape Plan\03-002-004\_Plan1 - LP.dwg

**NORTH**

0 10' 20' 40'

Scale: 1" = 20'-0"

Date: 03.15.2014  
Project No.: 03-002.004  
Designed By: TLM  
Drawn By: TLM  
Checked By: SCM/AB

**Revision Dates:**

10-01-2014	Revisions	10-30-15	Resubmittal
01-29-2014	Revisions	11-24-15	Resubmittal
01-07-2015	Revisions		
02-19-2015	Revisions		
03-11-2015	Revisions		
04-24-2015	Revisions		
05-18-2015	Revisions		
07-31-2015	Revisions		
09-15-2015	50% CD Submittal		
10-07-2015	50% CD Resubmittal		

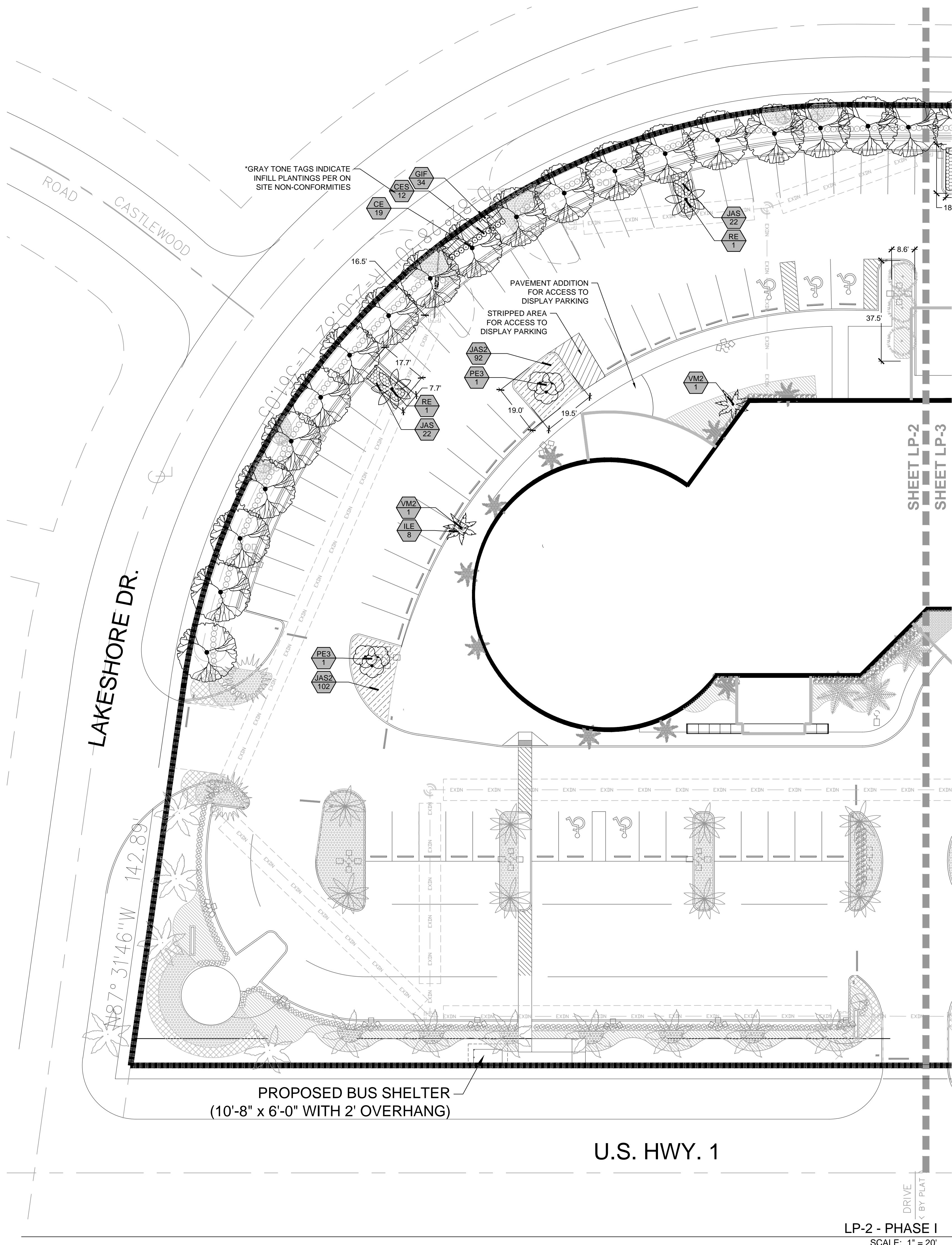

LP-2 - PHASE I  
SCALE: 1" = 20'

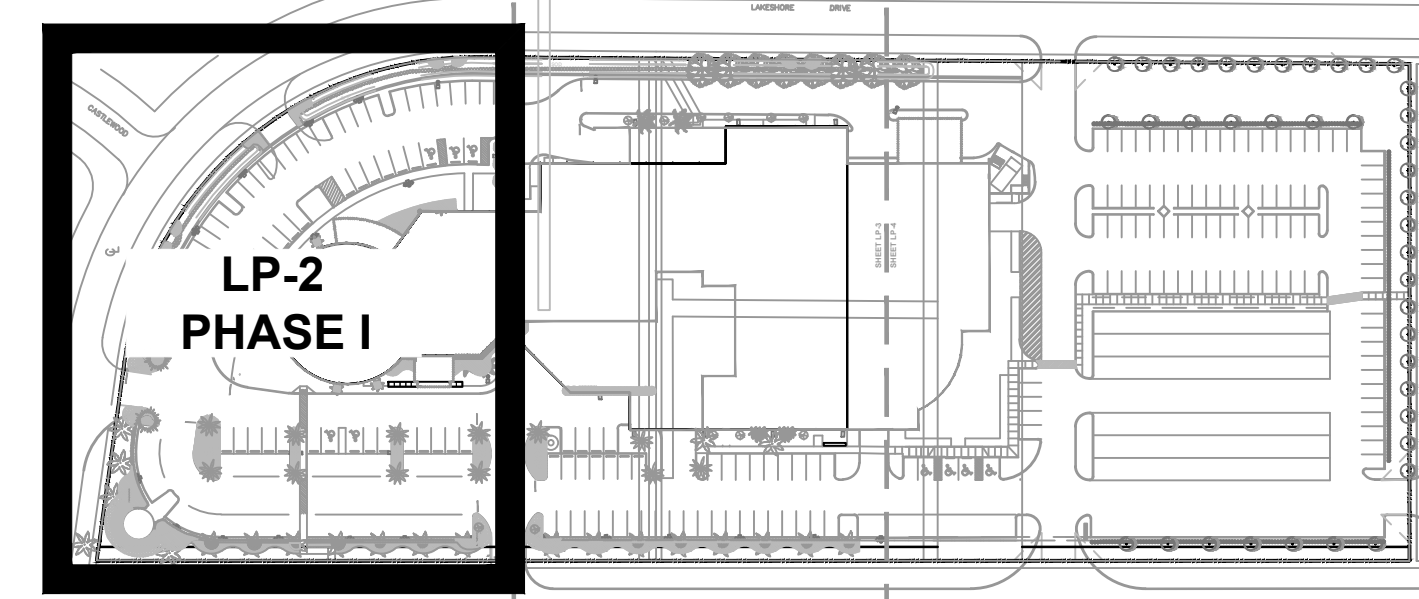

KEY MAP  
N.T.S.

**Urban design  
kilday  
STUDIOS**  
Urban Planning & Design  
Landscape Architecture  
Communication Graphics

The Offices at City Place  
477 S. Rosemary Ave., Suite 225  
West Palm Beach, FL 33401  
561.366.1100 FAX 561.366.1111  
www.udkstudios.com  
#LCC000035

Copyright:  
All ideas, designs, arrangements, and plans represented by this drawing are owned by and the property of the designer, and were created for the exclusive use of the specified project. These ideas, designs, arrangements or plans shall not be used by, or disclosed to any person, firm, or corporation without the written permission of the designer.

PLANT SCHEDULE OVERALL		
TREES	CODE	BOTANICAL NAME / COMMON NAME
	CE	Conocarpus erectus / Green Buttonwood *
	CS	Conocarpus erectus sericeus / Silver Button Wood *
	LIG	Ligustrum japonicum / Japanese Privet
	PE2	Pychosperma elegans / Alexander Palm
	PE3	Pychosperma elegans / Alexander Palm
	PE4	Pychosperma elegans / Alexander Palm
	QV	Quercus virginiana / Southern Live Oak *
	RE	Roystonea elata / Florida Royal Palm*
	SP	Sabal palmetto / Cabbage Palmetto*
	SQ	Syagrus romanzoffiana / Queen Palm
	VM3	Veitchia merrillii / Triple Christmas Palm
	VM2	Veitchia montgomeryana / Montgomery Palm
SHRUBS	CODE	BOTANICAL NAME / COMMON NAME
	CHR	Chrysobalanus icaco / Red Tip / Red Tip Cocoplum *
	CES	Conocarpus erectus / Silver Buttonwood *
SHRUB AREAS	CODE	BOTANICAL NAME / COMMON NAME
	CAR	Carissa macrocarpa / Emerald Blanket / Emerald Blanket Carissa *
	DJR	Duranta erecta / Gold Mound / Gold Mound Duranta *
	GIF	Ficus microcarpa / Green Island / Green Island Ficus
	ILE	Ilex vomitoria / Stokes Dwarf / Dwarf Yaupon *
	JAS	Jasminum multiflorum / Downey Jasmine *
	JAS2	Jasminum volubile / Wax Jasmine *
	PIT	Pittosporum tobira / Variegata / Variegated Pittosporum *
	PLU	Plumbago auriculata / Imperial Blue / Blue Plumbago *
	TRA	Trachelospermum jasminoides / Star Jasmine Trellis

\* Denotes Town of Lake Park Preferred Plan List species

**Earl Stewart Toyota**  
Lake Park, FL  
Landscape Plan - Phase I

03-002-004  
03-15-2014  
TLM  
TLM  
SCM/AB

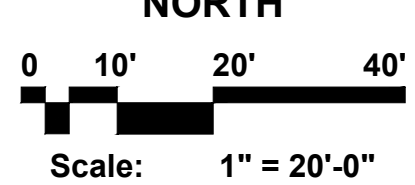
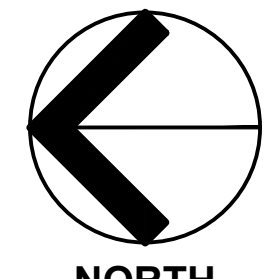

Date: 03.15.2014  
Project No.: 03-002.004  
Designed By: TLM  
Drawn By: TLM  
Checked By: SCM/AB

**Revision Dates:**

10-01-2014	Revisions	10-30-15	Resubmittal
10-29-2014	Revisions	11-24-15	Resubmittal
01-07-2015	Revisions		
02-18-2015	Revisions		
03-11-2015	Revisions		
04-24-2015	Revisions		
05-18-2015	Revisions		
07-31-2015	Revisions		
09-15-2015	50% CD Submittal		
10-07-2015	50% CD Resubmittal		

**LP-2**  
of 6

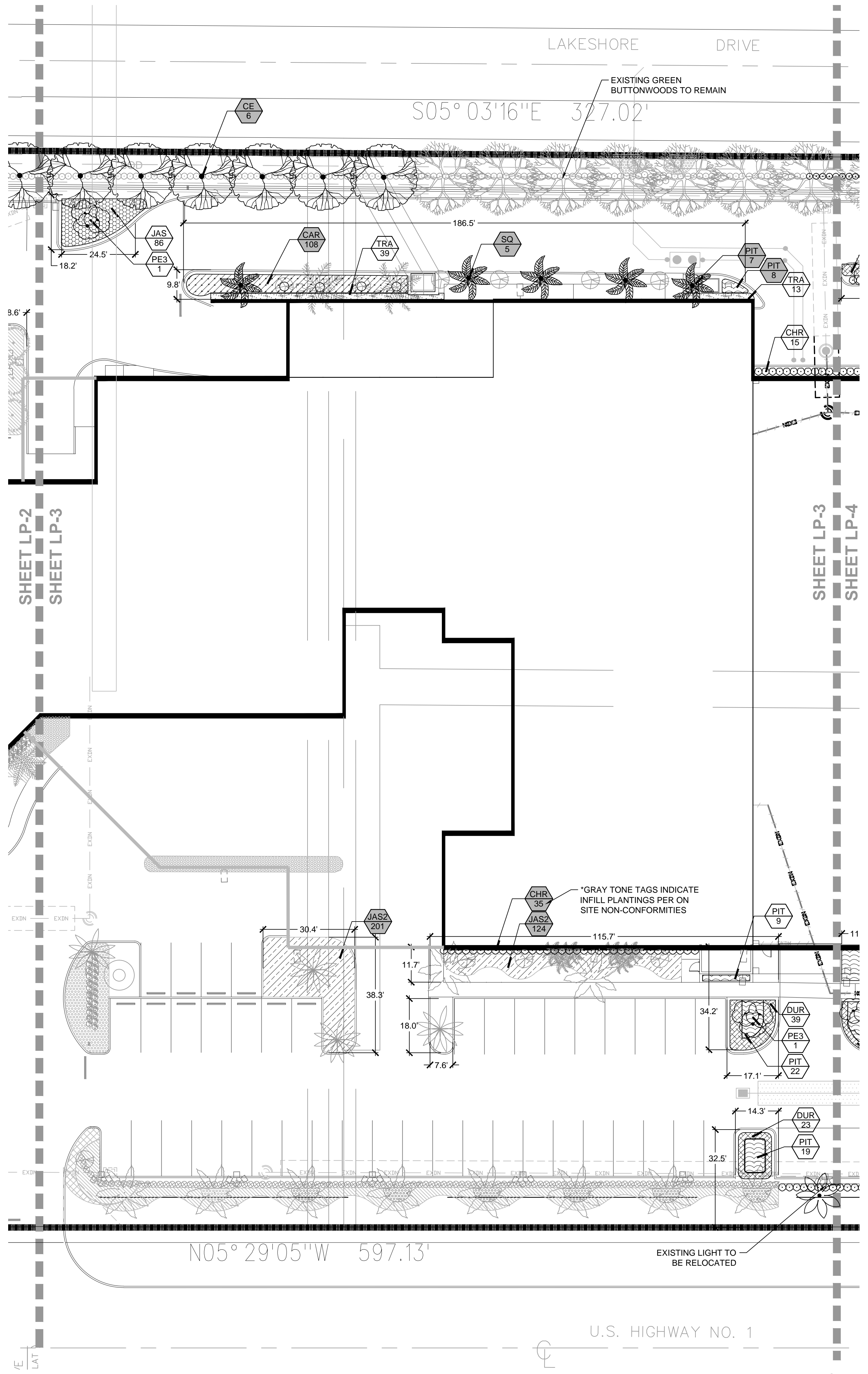

LP-3 - PHASE I  
SCALE: 1" = 20'

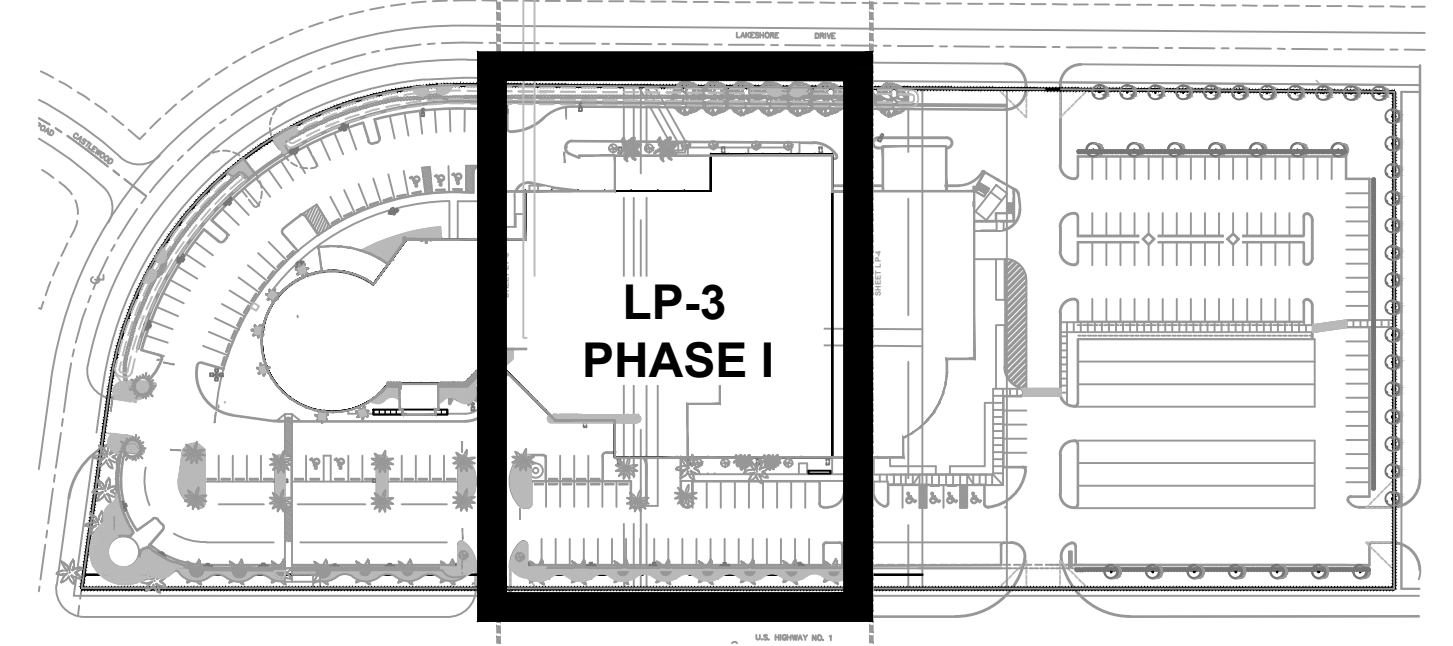

KEY MAP  
N.T.S.

PLANT SCHEDULE OVERALL		
TREES	CODE	BOTANICAL NAME / COMMON NAME
	CE	Conocarpus erectus / Green Buttonwood *
	CS	Conocarpus erectus sericeus / Silver Button Wood *
	LIG	Ligustrum japonicum / Japanese Privet
	PE2	Ptychosperma elegans / Alexander Palm
	PE3	Ptychosperma elegans / Alexander Palm
	PE4	Ptychosperma elegans / Alexander Palm
	QV	Quercus virginiana / Southern Live Oak *
	RE	Roystonea elata / Florida Royal Palm*
	SP	Sabal palmetto / Cabbage Palmetto*
	SQ	Syagrus romanzoffiana / Queen Palm
	VM3	Veitchia merrillii / Triple Christmas Palm
	VM2	Veitchia montgomeryana / Montgomery Palm
SHRUBS	CODE	BOTANICAL NAME / COMMON NAME
	CHR	Chrysobalanus icaco / Red Tip / Red Tip Cocoplum *
	CES	Conocarpus erectus / Silver Buttonwood *
SHRUB AREAS	CODE	BOTANICAL NAME / COMMON NAME
	CAR	Carissa macrocarpa 'Emerald Blanket' / Emerald Blanket Carissa *
	DUR	Duranta erecta 'Gold Mound' / Gold Mound Duranta *
	GIF	Ficus microcarpa 'Green Island' / Green Island Ficus
	ILE	Ilex vomitoria 'Stokes Dwarf' / Dwarf Yaupon *
	JAS	Jasminum multiflorum / Downey Jasmine *
	JAS2	Jasminum volubile / Wax Jasmine *
	PIT	Pittosporum tobira 'Variegata' / Variegated Pittosporum *
	PLU	Plumbago auriculata 'Imperial Blue' / Blue Plumbago *
	TRA	Trachelospermum jasminoides / Star Jasmine Trellis

\* Denotes Town of Lake Park Preferred Plan List species

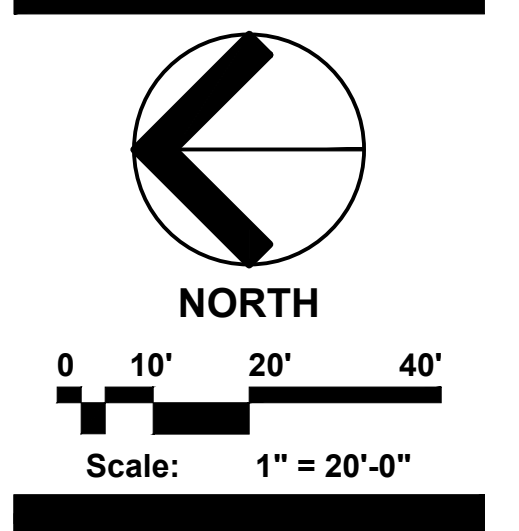

Date: 03.15.2014  
Project No.: 03-002.004  
Designed By: TLM  
Drawn By: TLM  
Checked By: SCM/AB

**Revision Dates:**

10-01-2014 Revisions	10-30-15 Resubmittal
10-29-2014 Revisions	11-24-15 Resubmittal
01-07-2015 Revisions	
02-18-2015 Revisions	
03-11-2015 Revisions	
04-24-2015 Revisions	
05-18-2015 Revisions	
07-31-2015 Revisions	
09-15-2015 50% CD Submittal	
10-07-2015 50% CD Resubmittal	

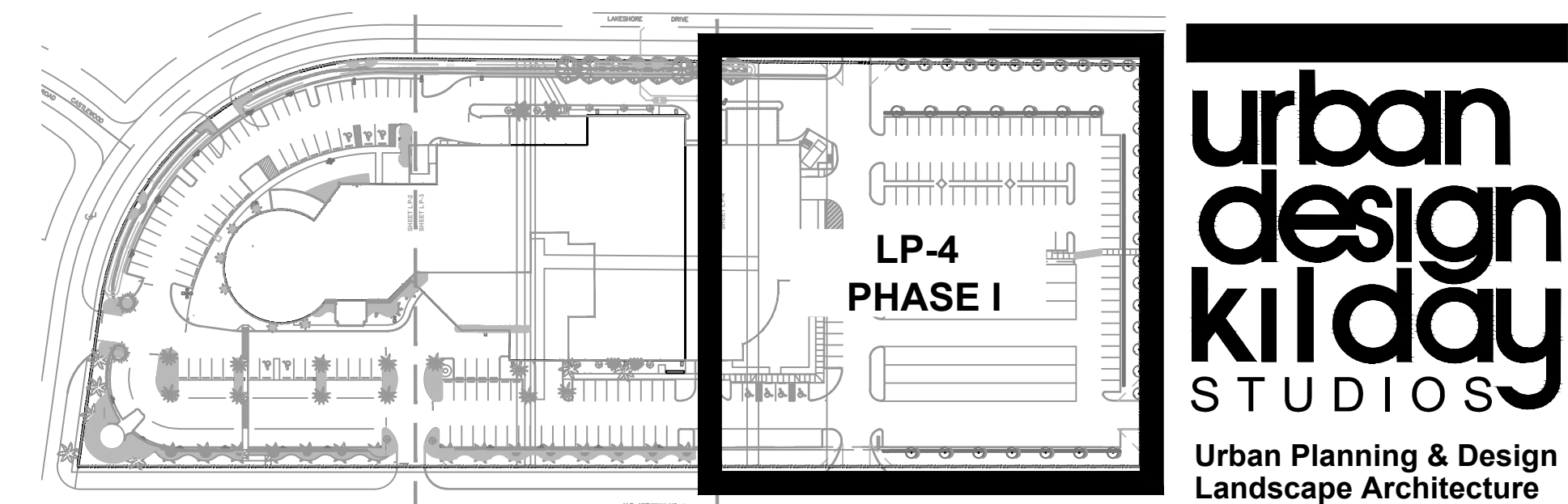

**Urban design kilday studios**  
 Urban Planning & Design  
 Landscape Architecture  
 Communication Graphics

**KEY MAP**  
 N.T.S. The Offices at City Place  
 477 S. Rosemary Ave., Suite 225  
 West Palm Beach, FL 33401  
 561.366.1100 FAX 561.366.1111  
 www.udkstudios.com  
 #LCC000035

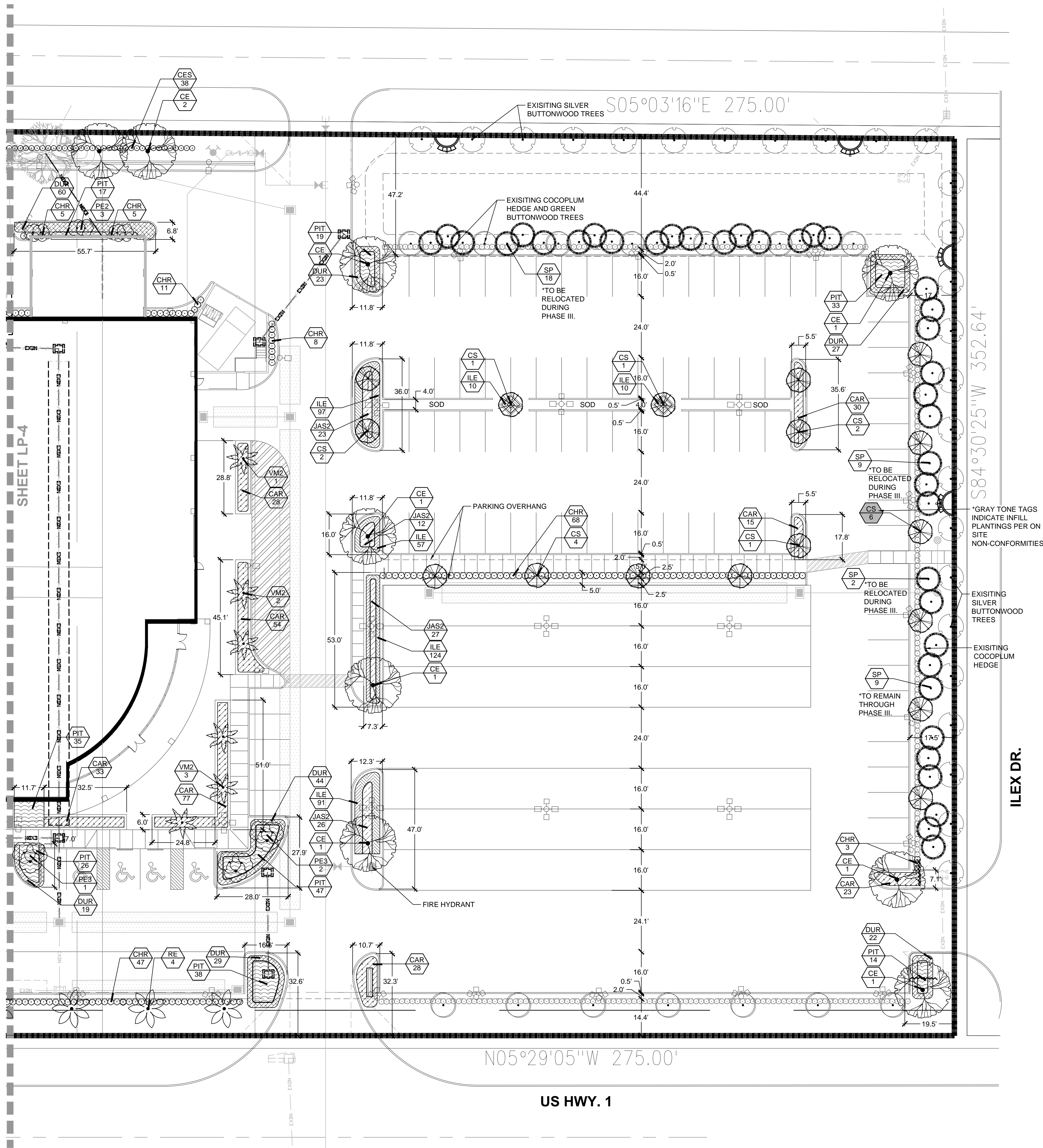

PLANT SCHEDULE OVERALL		
TREES	CODE	BOTANICAL NAME / COMMON NAME
	CE	Conocarpus erectus / Green Buttonwood *
	CS	Conocarpus erectus sericeus / Silver Button Wood *
	LIG	Ligustrum japonicum / Japanese Privet
	PE2	Ptychosperma elegans / Alexander Palm
	PE3	Ptychosperma elegans / Alexander Palm
	PE4	Ptychosperma elegans / Alexander Palm
	QV	Quercus virginiana / Southern Live Oak *
	RE	Roystonea elata / Florida Royal Palm *
	SP	Sabal palmetto / Cabbage Palmetto *
	SO	Syagrus romanzoffiana / Queen Palm
	VM3	Veitchia merrillii / Triple Christmas Palm
	VM2	Veitchia montgomeryana / Montgomery Palm
SHRUBS	CODE	BOTANICAL NAME / COMMON NAME
	CHR	Chrysobalanus icaco / Red Tip / Red Tip Cocoplum *
	CES	Conocarpus erectus / Silver Buttonwood *
SHRUB AREAS	CODE	BOTANICAL NAME / COMMON NAME
	CAR	Carissa macrocarpa / Emerald Blanket / Emerald Blanket Carissa *
	DUR	Duranta erecta / Gold Mound / Gold Mound Duranta *
	GIF	Ficus microcarpa / Green Island / Green Island Ficus
	ILE	Ilex vomitoria / Stokes Dwarf / Dwarf Yaupon *
	JAS	Jasminum multiflorum / Downey Jasmine *
	JAS2	Jasminum volubile / Wax Jasmine *
	PIT	Pittosporum tobira / Variegata / Variegated Pittosporum *
	PLU	Plumbago auriculata / Imperial Blue / Blue Plumbago *
	TRA	Trachelospermum jasminoides / Star Jasmine Trellis

\* Denotes Town of Lake Park Preferred Plan List species

**Earl Stewart Toyota**  
 Lake Park, FL  
 Landscape Plan - Phase I

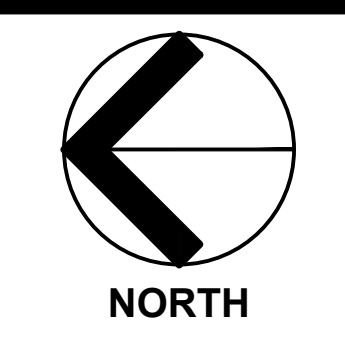

0 10' 20' 40'  
 Scale: 1" = 20'-0"

Date: 03.15.2014  
 Project No.: 03-002.004  
 Designed By: TLM  
 Drawn By: TLM  
 Checked By: SCM/AB

Revision Dates:	
10-01-2014 Revisions	10-30-15 Resubmittal
10-29-2014 Revisions	11-24-15 Resubmittal
01-07-2015 Revisions	
02-18-2015 Revisions	
03-11-2015 Revisions	
04-24-2015 Revisions	
05-18-2015 Revisions	
07-31-2015 Revisions	
09-15-2015 50% CD Submittal	
10-07-2015 50% CD Resubmittal	

**LP-4**  
 of 6

LP-4 - PHASE I  
 SCALE: 1" = 20'

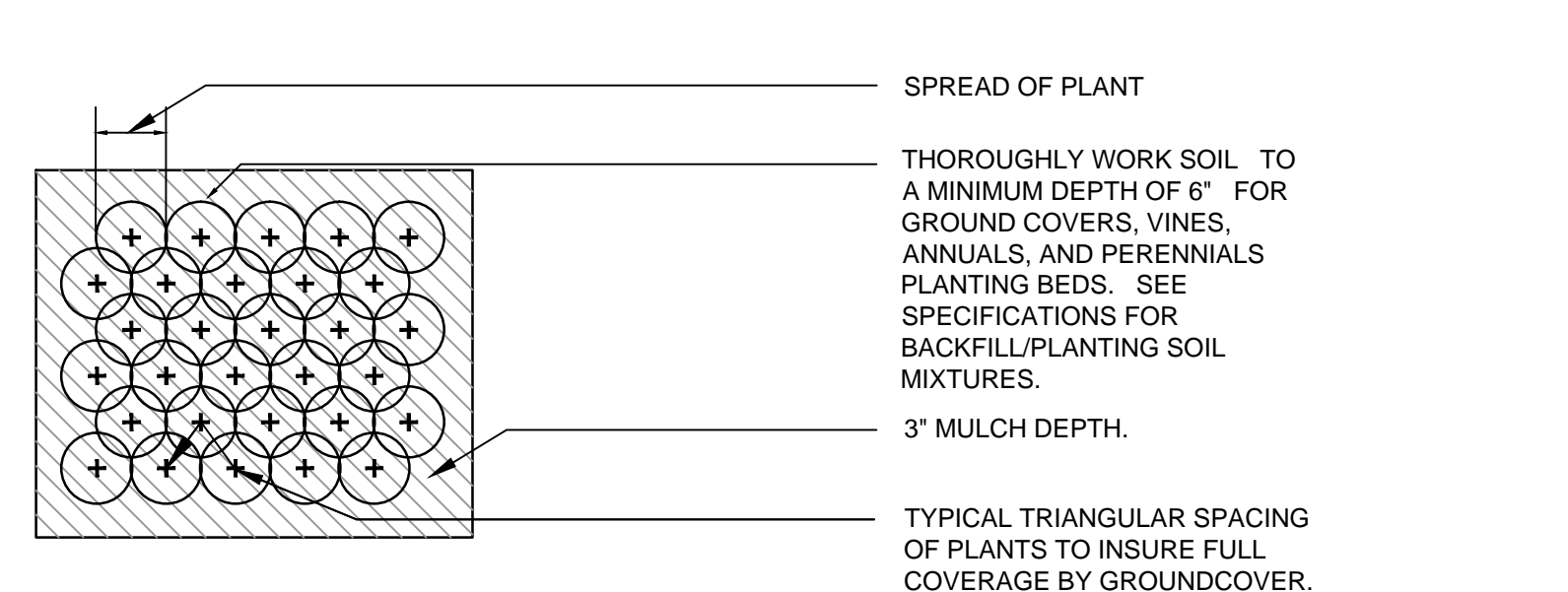
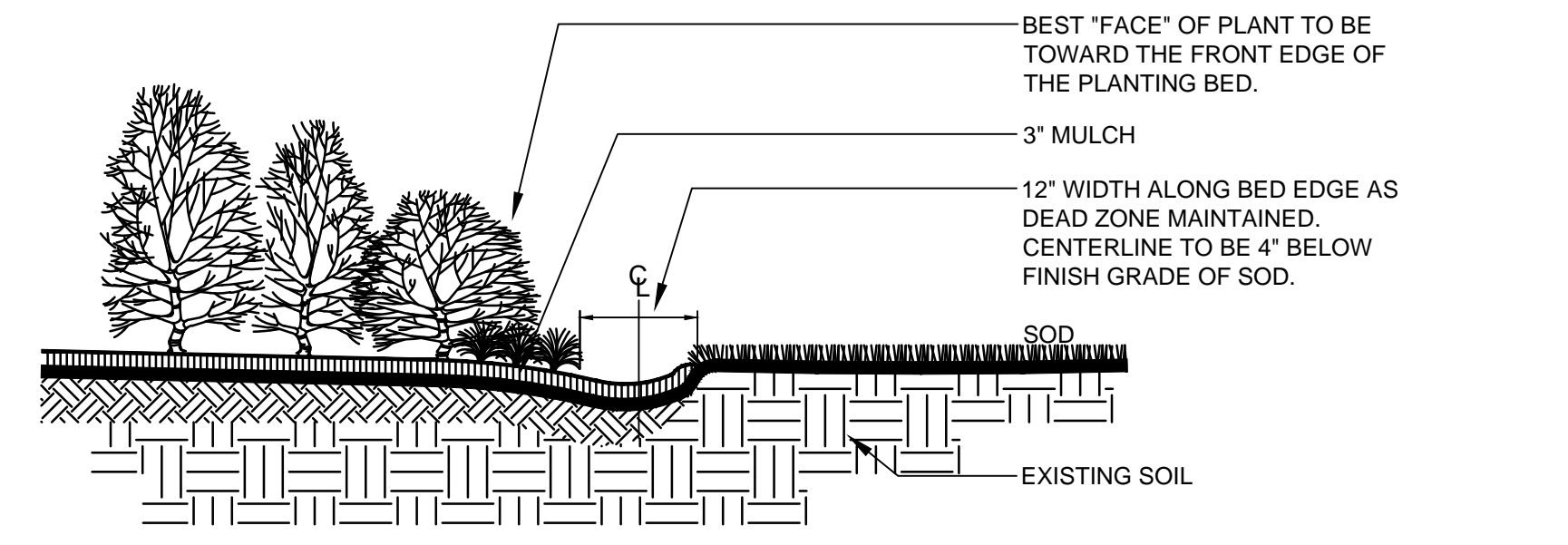

**PLANTING BED EDGE**

NOT TO SCALE

**GROUND COVERS & ROOTED CUTTING**

NOT TO SCALE

ROOT BARRIER TO BE PROVIDED BY DEEP ROOT, SPECIFIED AS PANEL TYPE - UB36-2 OR APPROVED EQUAL. ROOT BARRIER TO BE PROVIDED WHEN A LIVE OAK TREE IS BETWEEN 10-15' FROM SEACOAST UTILITY LINES.

**UB 36-2/UB 48-2 Specifications  
36" / 48" DeepRoot Tree Root Barrier**

Specified tree root barriers are a mechanical barrier and root deflector to prevent tree roots from damaging hardscapes, and landscapes. Assembled in 2' (61 cm) long modules to create varying lengths for linear applications directly beside a hardscape adjacent to one side of the trees or for large perimeter surround applications with a minimum 6' (2.43 m) diameter using 12 panels.

**A. Materials**  
1. The contractor shall furnish and install tree root barriers as specified. The tree root barriers shall be either product # UB 36-2 or UB 48-2 as manufactured by DeepRoot Partners, L.P., 81 Langton Street, Suite 4, San Francisco, CA 94103 (800.458.7668), or approved equal. The barrier shall be black, Extruded Panels, of 0.80" (2.03mm) wall thickness in modules 24" (61cm) long either 36" (91 cm) or 48" (122 cm) deep, manufactured with homopolymer polyethylene with added ultraviolet inhibitors; recyclable. Each 2' (61 cm) section shall have:

Not less than 4 Molded Integral Vertical Root Directing Ribs of a minimum 0.080" (2.03mm) thickness protruding 1/2" (12.7 mm) at 90° from interior of the barrier panel, spaced 6" (152.4 mm) apart. See panel drawing.

An integrated Joining System providing for instant assembly by sliding one panel into another.

The basic properties of the material shall be:

Material and Thickness		
Homopolymer Polyethylene 0.080 inch Extruded		
Properties	ASTM Test Method	Typical Value
Tensile stress @ yield	D638	3800 PSI
Elongation @ break %	D638	10%
Tensile Modulus	D638	155,000 PSI
Notched Izod Impact	D256A	0.4 - 4.0
Flexural Modulus 73	PSI D790	145,000
Hardness Shore	D2240	P66

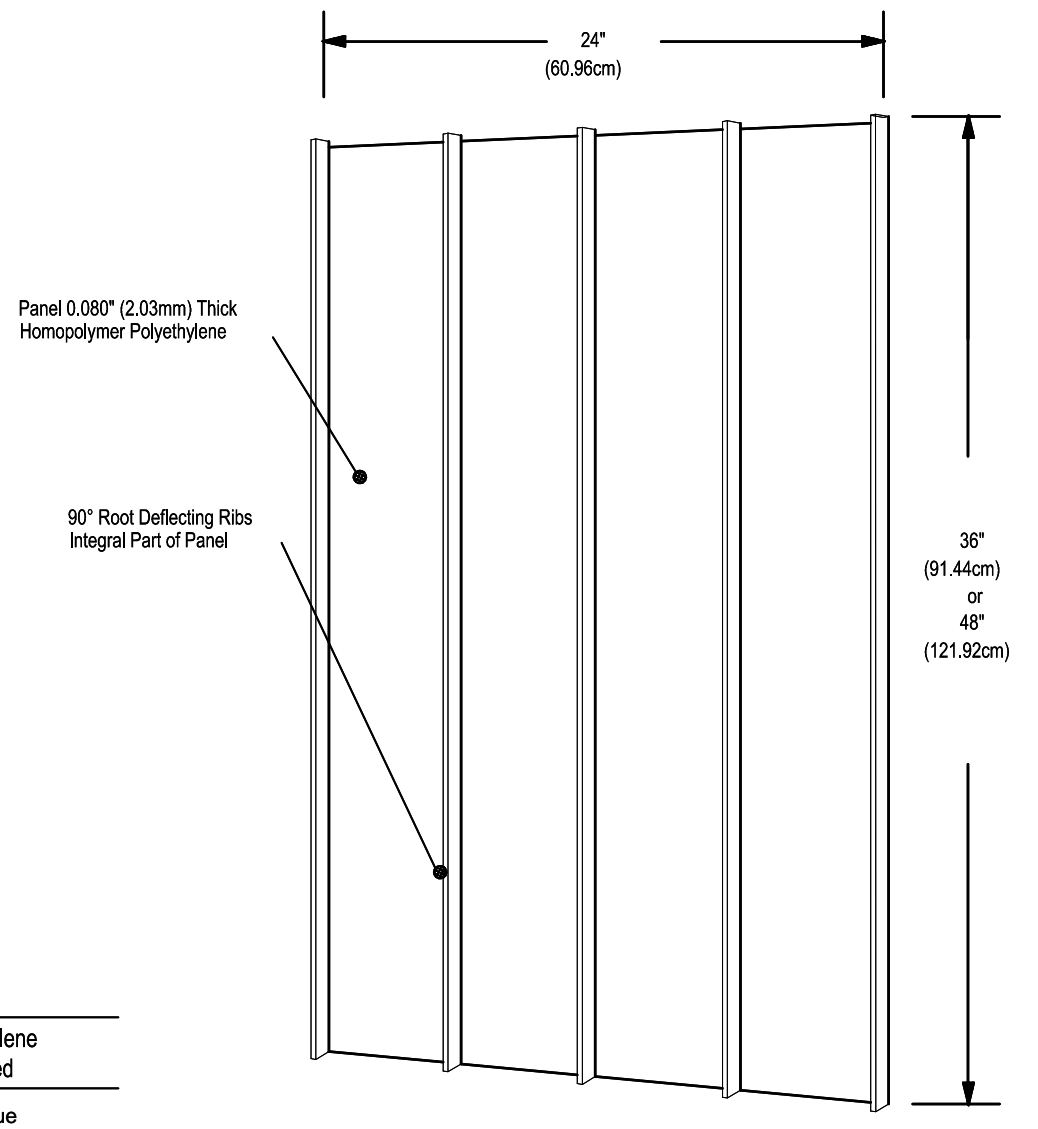

A Typical Linear Planting Installation Using DeepRoot UB 36-2 or UB 48-2

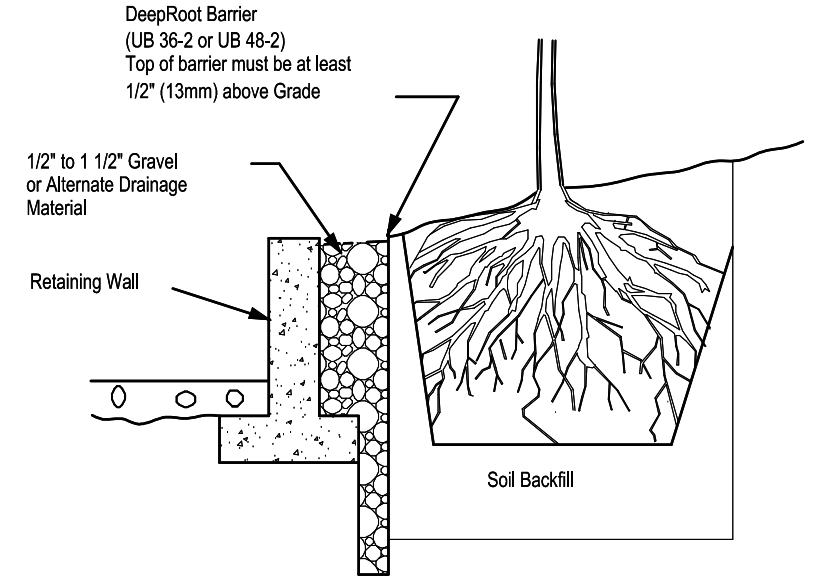

Install DeepRoot UB 36-2 or UB 48-2 6'-12' behind planter or retaining wall.

**B. Construction and Installation**

1. The contractor shall install the tree root barriers with the number of panels and in the manner shown on the drawings. The vertical root directing rib shall be facing inward to the root ball and the top edge shall be 1/2" (12.7 mm) above grade. Each of the required number of panels shall be joined in a linear fashion and placed along the adjacent hardscape or where specified connected to form a circle around the root ball.

2. Excavation and preparation shall conform to the drawings.

**ROOT BARRIER DETAILS**

NOT TO SCALE

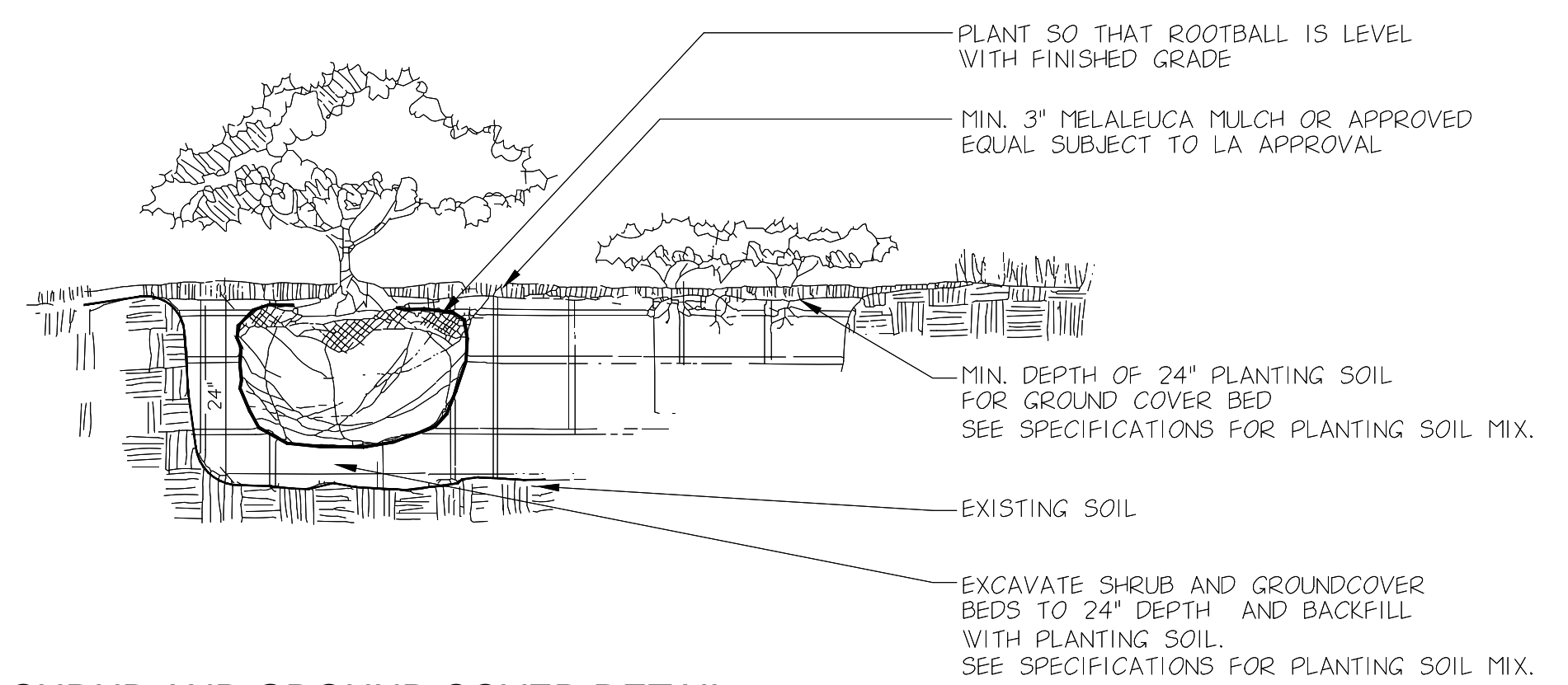

**SHRUB AND GROUND COVER DETAIL**

NOT TO SCALE

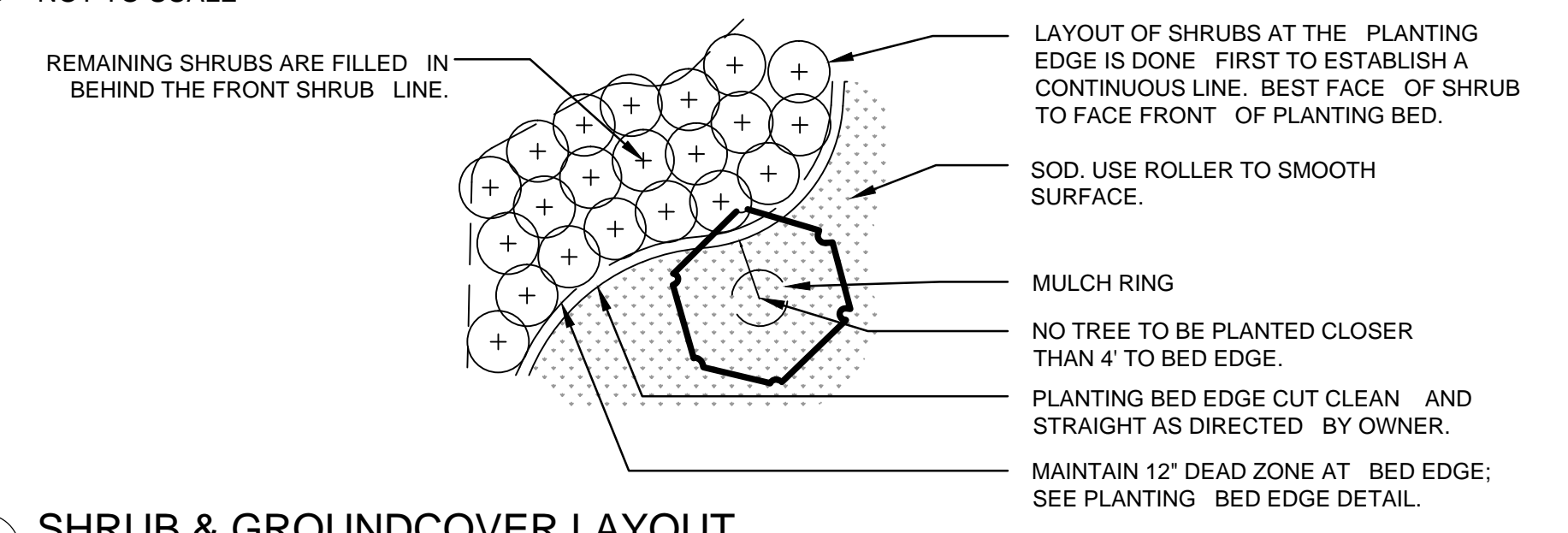

**SHRUB & GROUND COVER LAYOUT**

NOT TO SCALE

**MULCH RING IN SOD DETAIL**

NOT TO SCALE

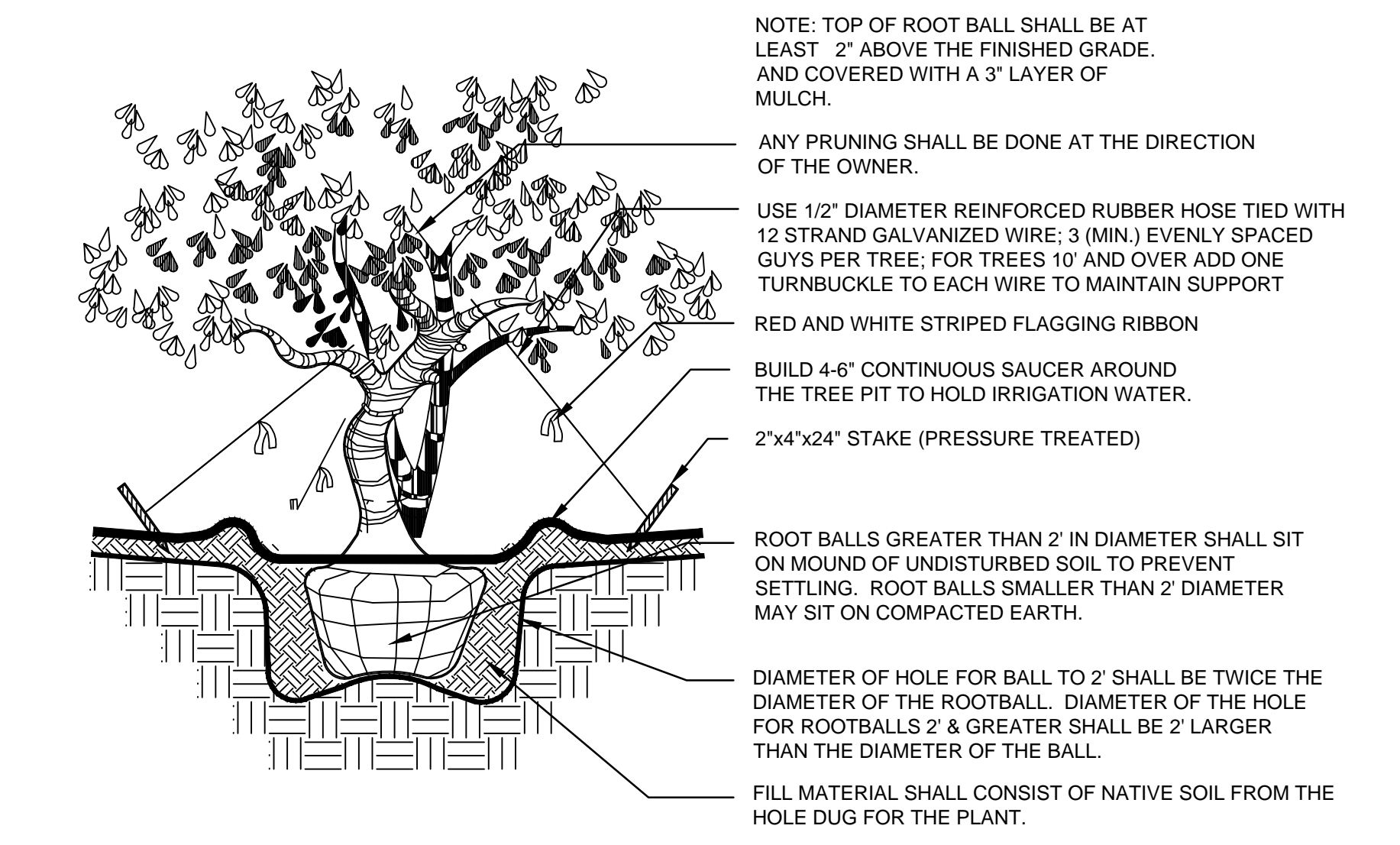
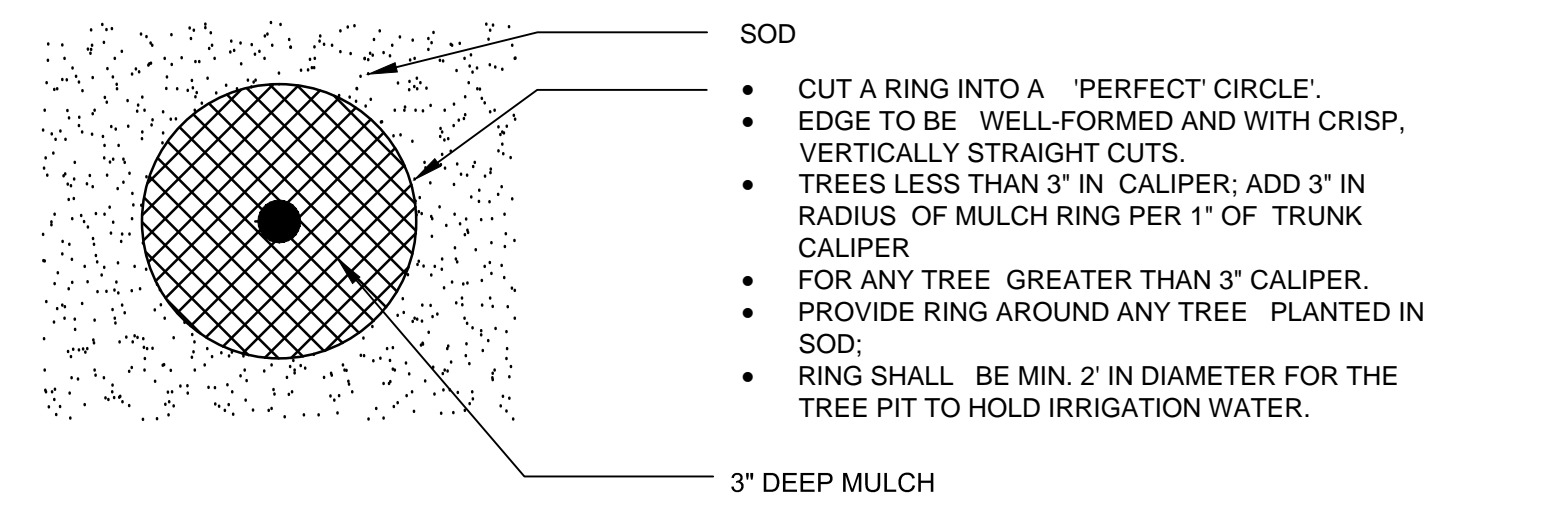

**IRREGULAR & MULTI-STEM TREE PLANTING**

NOT TO SCALE

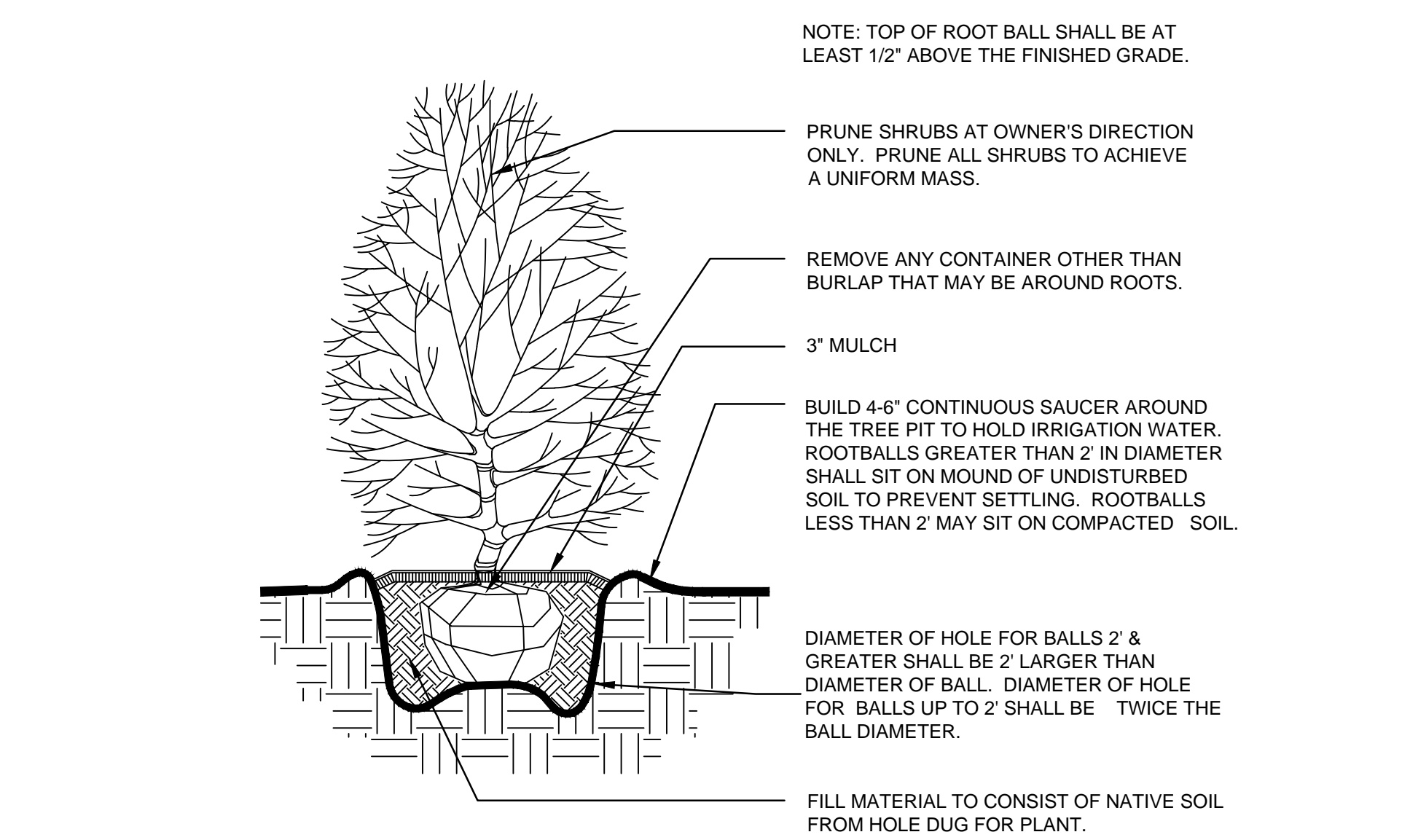

**LARGE SHRUB PLANTING**

NOT TO SCALE

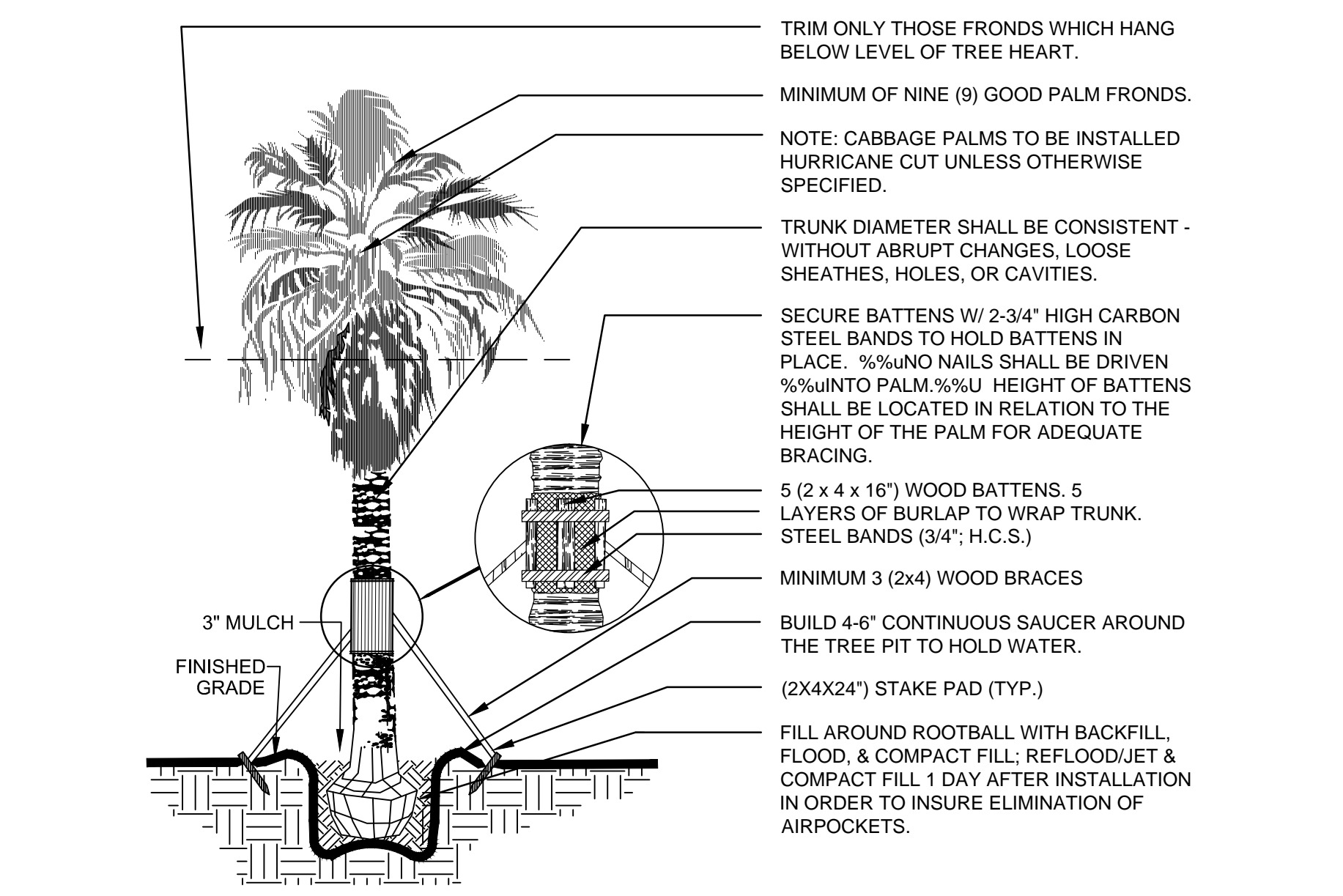

**TYPICAL PALM PLANTING**

NOT TO SCALE

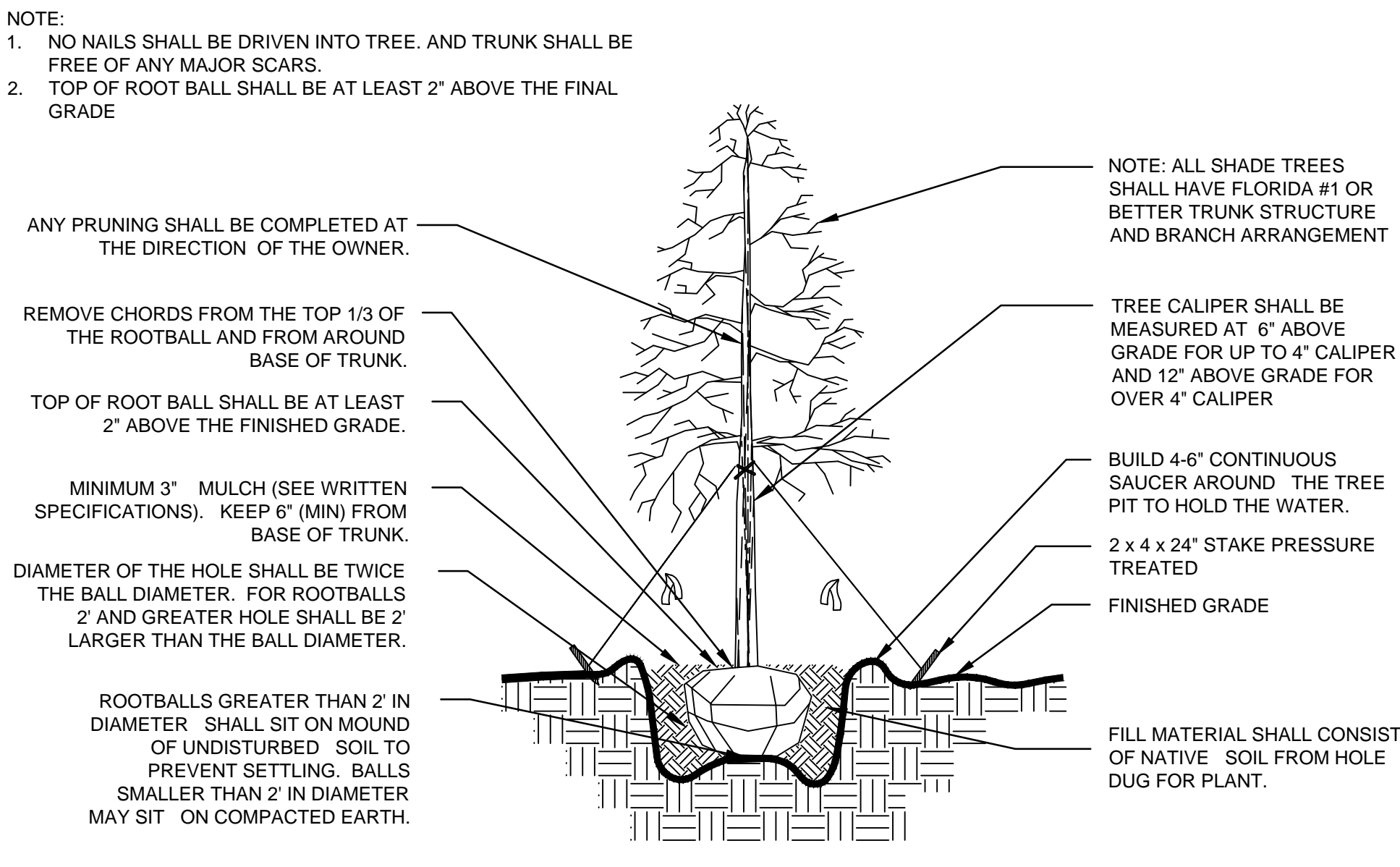

**TREE PLANTING (2"-4" CALIPER)**

NOT TO SCALE

Date: 03.15.2014  
Project No.: 03-002.004  
Designed By: TLM  
Drawn By: TLM  
Checked By: SCM/AB

**Revision Dates:**

10-01-2014 Revisions	10-30-15 Resubmittal
10-29-2014 Revisions	11-24-15 Resubmittal
01-07-2015 Revisions	
02-18-2015 Revisions	
03-11-2015 Revisions	
04-24-2015 Revisions	
05-18-2015 Revisions	
07-31-2015 Revisions	
09-15-2015 50% CD Submittal	
10-07-2015 50% CD Resubmittal	

