



**Minutes  
Town of Lake Park, Florida  
Public Workshop on the  
Design Elements for the Park Avenue  
And 10<sup>th</sup> Street Safety and Landscape Improvements  
Monday, January 24, 2022 6:30 PM  
Town Hall Commission Chamber,  
535 Park Avenue, Lake Park, Florida 33403**

The Public Workshop to discuss the design elements for the Park Avenue and 10<sup>th</sup> Street safety and landscape improvements was held on Monday, January 24, 2022, at 6:30 p.m. Present were Mayor Michael O'Rourke, Vice-Mayor Kimberly Glas-Castro, Commissioners John Linden, Roger Michaud, Town Manager John D'Agostino, Public Works Director Roberto Travieso, Project Manager John Wille, Operations Manager Dwayne Bell and Town Clerk Vivian Mendez.

Public Works Director Travieso welcomed everyone to the meeting. Operations Manager Bell led the pledge of allegiance.

Public Works Director Travieso explained that the purpose of the workshop was to discuss design options for Park Avenue and 10<sup>th</sup> Street. Mr. Hays Henderson, PLA of JMorton presented to the audience (see Exhibit "A"). After a recess so that audience members could discuss and review the design options with staff, the meeting reconvened. Mr. Henderson and staff responded to questions from the audience.

Mr. Chris O'Brien commented on the drive flow of the area. He stated that the train adds value to the area. However, he suggested that a sound barrier be installed between the railroad tracks and the businesses to lower the sound of the passing train. Mr. Henderson felt that a knee wall was a great suggestion.

Ms. Evelyn Clark suggested having art in public places and statement trees planted around Town. Public Works Director Travieso explained that staff has been looking into sponsorship for trees as an option.

Ms. Gillian Kennedy Wright suggested the Town adopt a native plant pallet. She suggested shade trees, using well water for irrigation and agreed with art in public places. She asked if the planted pottery was made of plastic materials. She also asked if the stamped concrete would allow for drainage. Mr. Henderson explained that in Florida native plants are best around medians. He explained that there was a plan to improve the stormwater runoff on 10<sup>th</sup> Street. He agreed with art in public places and the Town would look to the community for feedback on the type of art. Public Works Director Travieso explained that as part of the Stormwater Master Plan, there are plans to provide low impact rain infrastructure to improve drainage and water treatments before the runoff discharges into the Lake Worth Lagoon. He further explained that the Town was pursuing grant opportunities to assist with other initiatives.

Mr. Brady Drew asked if there was a way to make 10<sup>th</sup> Street a bikeable roadway. Mr. Henderson explained that there was an opportunity to place a bike lane on 10<sup>th</sup> Street. However, a traffic study would be necessary to determine how to place a bike lane safely on 10<sup>th</sup> Street. He stated that it would be a challenge.

Mr. Chris O'Brien suggested using the alleyways along the CRA to install bike lanes.

Ms. Evelyn Clark asked if the Clock Tower on 7<sup>th</sup> Street and Park Avenue was going to be refreshed as part of this project. Public Works Director Travieso suggested asking the Centennial Celebration Committee to consider refreshing the Clock Tower as part of their role on that Committee.

Town Manager John D'Agostino recapped that many great suggestions had been discussed during this workshop. He explained that a public improvements fund would be developed as part of the Land Development Regulations. He explained that on Saturday, January 29<sup>th</sup> there would be a Community Redevelopment Agency (CRA) Master Plan Workshop, which was open to the public. He explained that a final workshop would be scheduled before a final plan is developed. He explained why the CRA has funds to accomplish these improvements. Lastly, he explained that Saturday's workshop would not cover Park Avenue east of 7<sup>th</sup> Street to US1. A workshop would be scheduled in the future to discuss that part of Park Avenue. In his opinion, there were three things that he would answer "yes" in this process: 1) was it affordable; 2) was it in the best interest of the Town 3) and could we make an improvement in the Town to move it forward. He thanked everyone for attending.

Mayor O'Rourke further explained Saturday's workshop to discuss the CRA Master Plan. He explained why the property values have increased and how that has improved the available funding in the CRA to accomplish these projects. He described changes to Ordinances that would change density in the CRA in the future. Art could be incorporated into development projects in the future.

Public Works Director Travieso thanked everyone for attending.

### ADJOURNMENT

There being no further business to discuss; the meeting adjourned at 7:40 p.m.



\_\_\_\_\_  
Mayor Michael O'Rourke

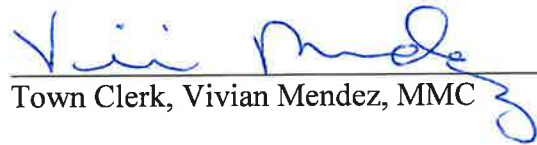

\_\_\_\_\_  
Town Clerk, Vivian Mendez, MMC



Approved on this 16 of February, 2022



**Public Workshop on the Design Elements  
for the Park Avenue and 10th Street Safety and  
Landscape Improvements**

Monday, January 24, 2022, 6:30-8:00 PM

Commission Chambers, Town Hall

**Meeting Agenda**

**Facilitator:** Roberto Travieso, Director of Public Works

WELCOME/OPENING COMMENTS	<b>ROBERTO TRAVIESO</b>
INTRODUCTIONS	
BACKGROUND	
PRESENTATION	<b>HAYS HENDERSON, PLA</b>
TABLE DISCUSSION	<b>ROBERTO TRAVIESO HAYS HENDERSON, PLA JOHN WILLE DWAYNE BELL</b>
Q&A	<b>ROBERTO TRAVIESO</b>
NEXT STEPS	<b>HAYS HENDERSON, PLA</b>
CLOSING COMMENTS	<b>JOHN D'AGOSTINO</b>

---

# DESIGN OPTIONS FOR PARK AVENUE & 10<sup>TH</sup> STREET LANDSCAPE AND STREETScape

DEPARTMENT OF PUBLIC WORKS

Project Manager  
Hays Henderson, PLA



# LOCATION, GOALS, AND OBJECTIVES



## Goals and Objectives

- 1) Create a complete streetscape environment to make the street network livable and safer for people walking, biking, driving, riding transit, and moving actively with assistive devices.
- 2) Provide for the Health Safety and Welfare of the pedestrian users when interacting with the vehicular traffic both along the street thoroughfare and at designated pedestrian crossings.
- 3) Allow for connectivity with adjacent uses and encourage interaction with commercial properties.
- 4) Prioritize a safe vehicular speed that allows for adequate traffic progress throughout the streetscape.
- 5) Enhance the pedestrian and driving experience along the streetscape through the use of landscape and hardscape elements.
- 6) Update and enhance the pedestrian and vehicular pavement systems through the use of decorative concrete and specialty unit pavers.
- 7) Create an attractive streetscape environment that provides layered amenities through the use of site appurtenances such as raised planters, bench seating pergolas for shade, water fountains, trash receptacles and landscape lighting.
- 8) Update the existing landscape to provide visual interest and year round color at a minimal maintenance commitment.

# CONCEPTUAL STREETSCAPE PLAN

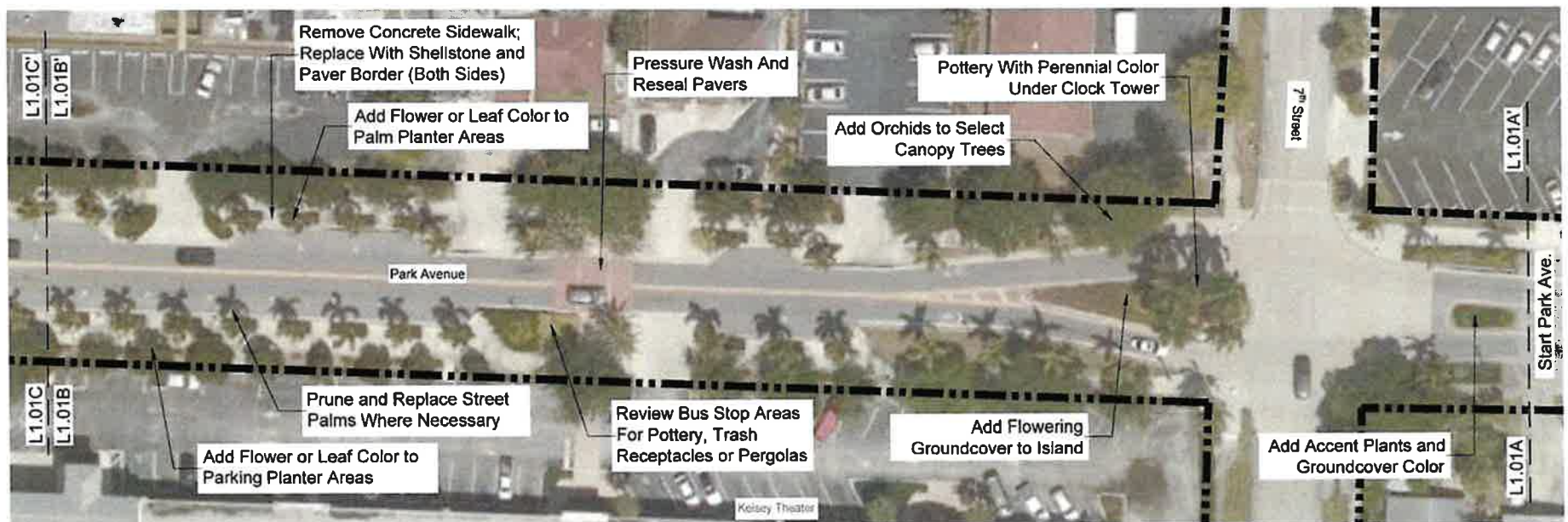

PLANTING LAYOUT A-A' - B-B'  
PLAN SCALE 1" = 20'



L1.01



# CONCEPTUAL STREETSCAPE PLAN

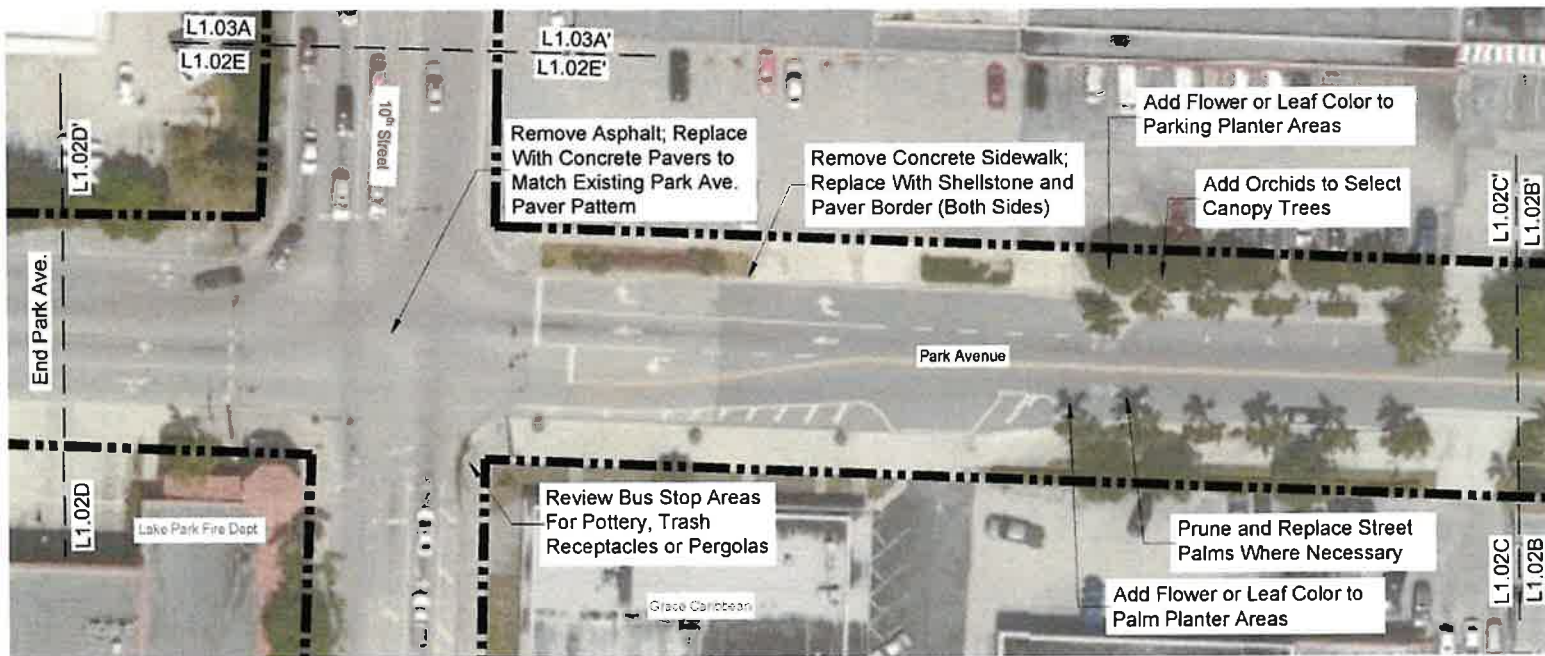

PLANTING LAYOUT C-C' - D-D'  
PLAN SCALE 1" = 20' L1.02



# CONCEPTUAL STREETSCAPE PLAN

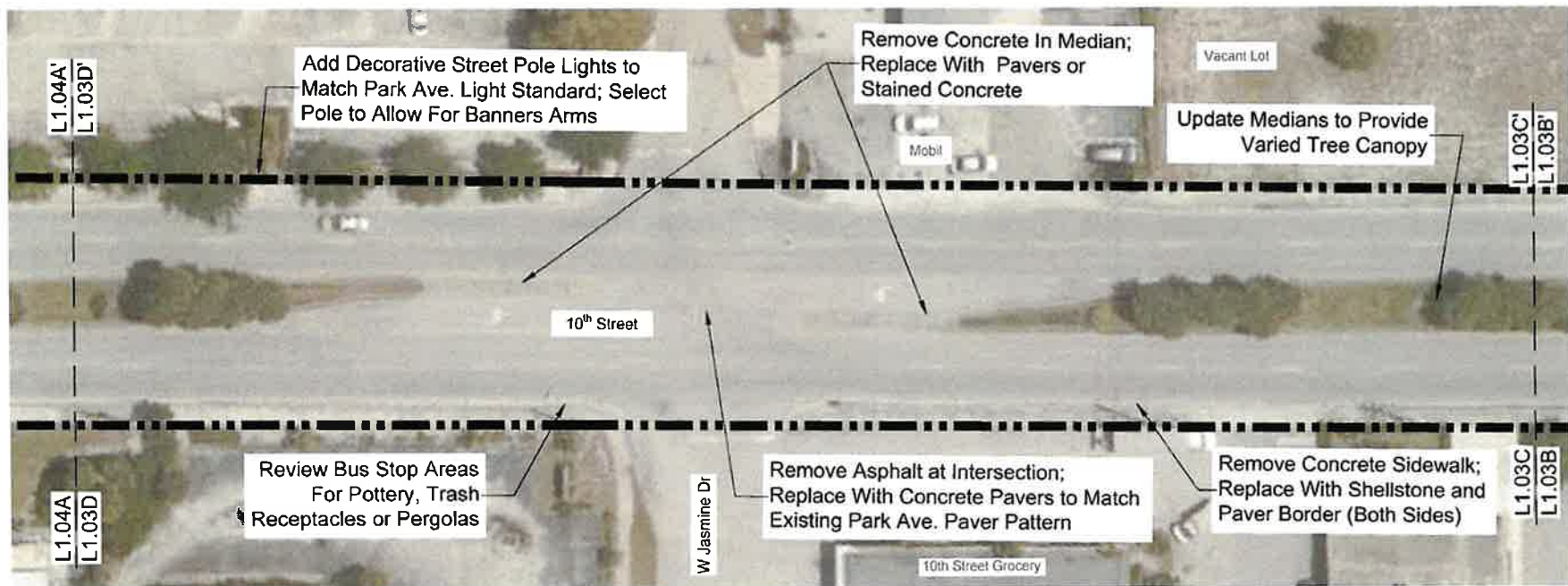

PLANTING LAYOUT C-C' - D-D'  
PLAN SCALE 1" = 20'



L1.03





# CONCEPTUAL STREETSCAPE TYPICAL SECTION

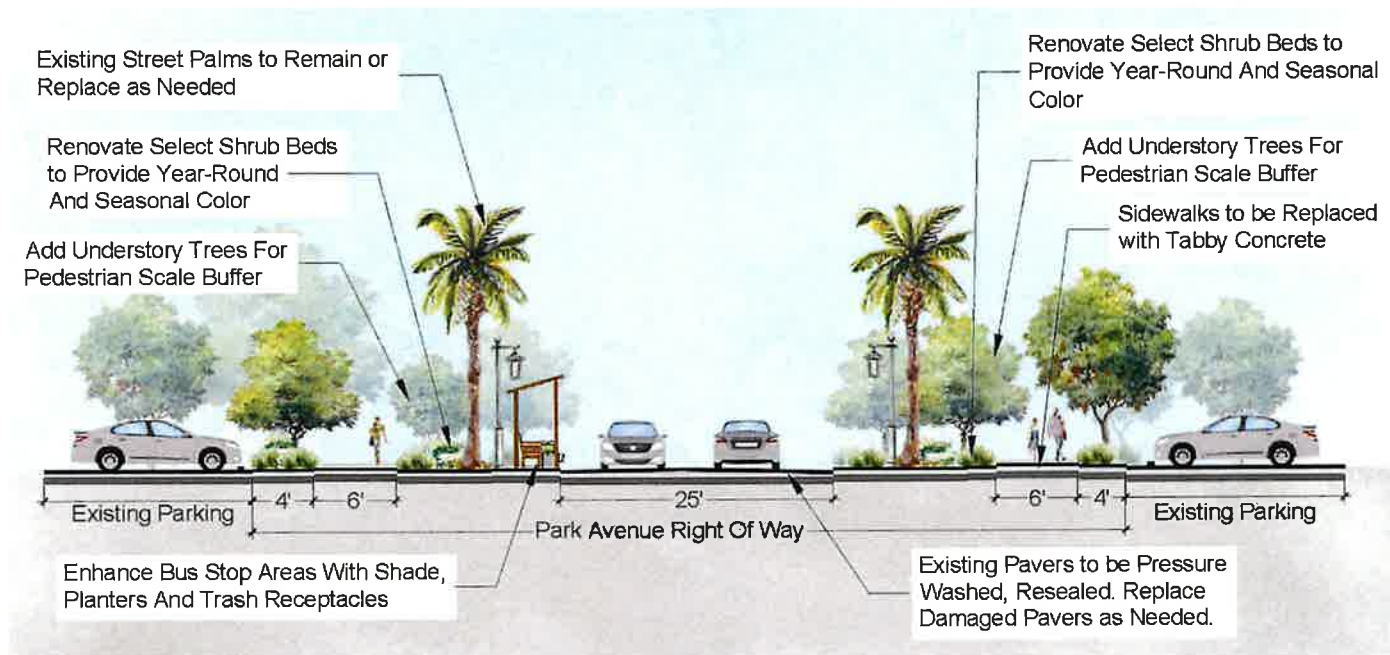

**PARK AVENUE TYPICAL SECTION**  
PLAN NTS

# CONCEPTUAL STREETSCAPE TYPICAL SECTION

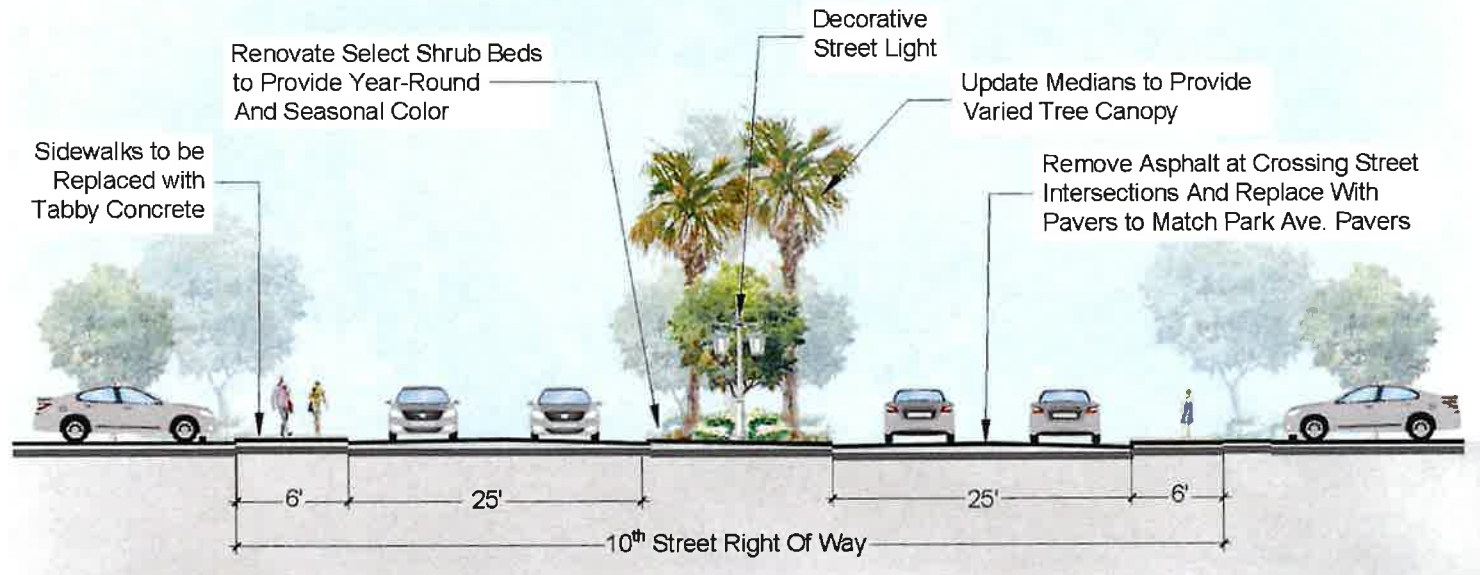

10TH STREET TYPICAL SECTION  
PLAN NTS

# CONCEPTUAL STREETScape DETAILS AND SPECIFICATIONS

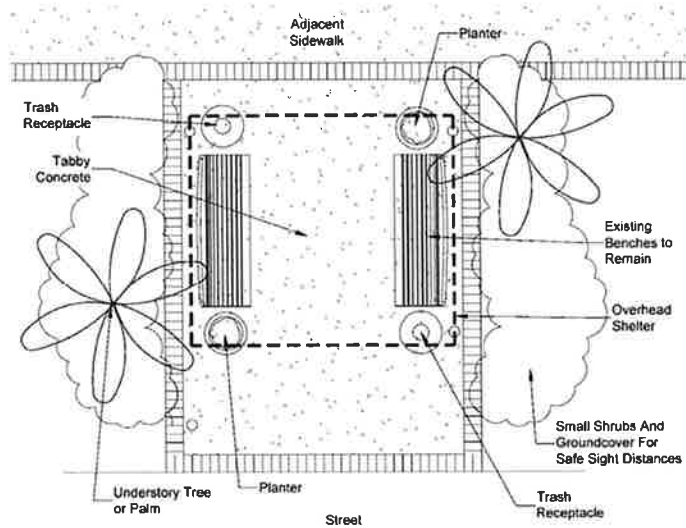

BUS STOP DETAIL  
PLAN HTS

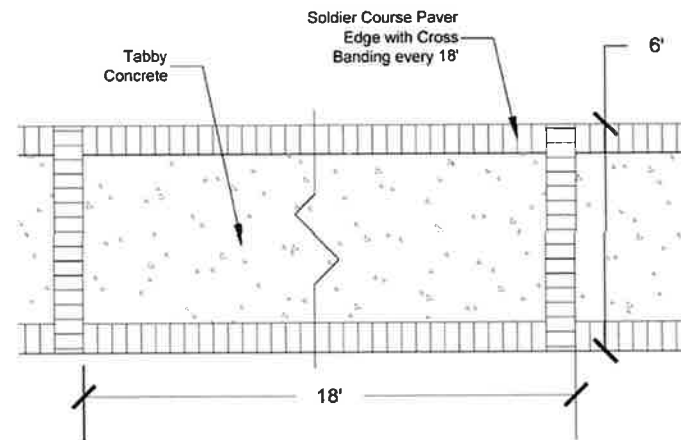

SIDEWALK PAVING DETAIL  
PLAN HTS

# PROPOSED STREET-SCAPE ENHANCEMENTS

Park Avenue (from 7<sup>th</sup> to 10<sup>th</sup> Street North)  
 10<sup>th</sup> Street (from Park Avenue to Northern Drive)

## DESCRIPTION OF ENHANCEMENT

## LEVEL OF INTEREST

### Safety Improvements and Hardscape Enhancements:

	Very High	Some What	Neutral	Very Low	None
1) REPLACE CONCRETE SIDEWALKS WITH DECORATIVE PAVERS	<input type="checkbox"/>	<input type="checkbox"/>	<input type="checkbox"/>	<input type="checkbox"/>	<input type="checkbox"/>
2) UP-GRADE BUS STOP AREAS W/ TRASH CANS / PLANT POTTERY / PERGOLAS	<input type="checkbox"/>	<input type="checkbox"/>	<input type="checkbox"/>	<input type="checkbox"/>	<input type="checkbox"/>
3) ADD PAVER ACCENTS TO INTERSECTIONS ALONG 10 <sup>TH</sup> STREET	<input type="checkbox"/>	<input type="checkbox"/>	<input type="checkbox"/>	<input type="checkbox"/>	<input type="checkbox"/>
4) ADD PAVER PEDESTRIAN CROSSWALK AT LOCATIONS ON 10TH STREET	<input type="checkbox"/>	<input type="checkbox"/>	<input type="checkbox"/>	<input type="checkbox"/>	<input type="checkbox"/>
5) ADD DECORATIVE LIGHT POLES ALONG 10 <sup>TH</sup> STREET (To Match Park Avenue)	<input type="checkbox"/>	<input type="checkbox"/>	<input type="checkbox"/>	<input type="checkbox"/>	<input type="checkbox"/>

### Landscape Improvements:

	Very High	Some What	Neutral	Very Low	None
6) ADD STREET-SIDE COLORFUL PLANT & FLOWER GROUND COVER	<input type="checkbox"/>	<input type="checkbox"/>	<input type="checkbox"/>	<input type="checkbox"/>	<input type="checkbox"/>
7) ADD ACCENT PLANT GROUND COVER AT STREET LANDSCAPE ISLANDS	<input type="checkbox"/>	<input type="checkbox"/>	<input type="checkbox"/>	<input type="checkbox"/>	<input type="checkbox"/>
8) ENHANCE TREES ALONG 10 <sup>TH</sup> AVENUE ( New Understory Trees and Palms)	<input type="checkbox"/>	<input type="checkbox"/>	<input type="checkbox"/>	<input type="checkbox"/>	<input type="checkbox"/>
9) ENHANCE BUS STOP AREAS BY ADDING POTTERY AND/OR PERGOLAS	<input type="checkbox"/>	<input type="checkbox"/>	<input type="checkbox"/>	<input type="checkbox"/>	<input type="checkbox"/>

### Other Comments:

---



---



---



---



---

**COME JOIN US & PROVIDE YOUR INPUT!**

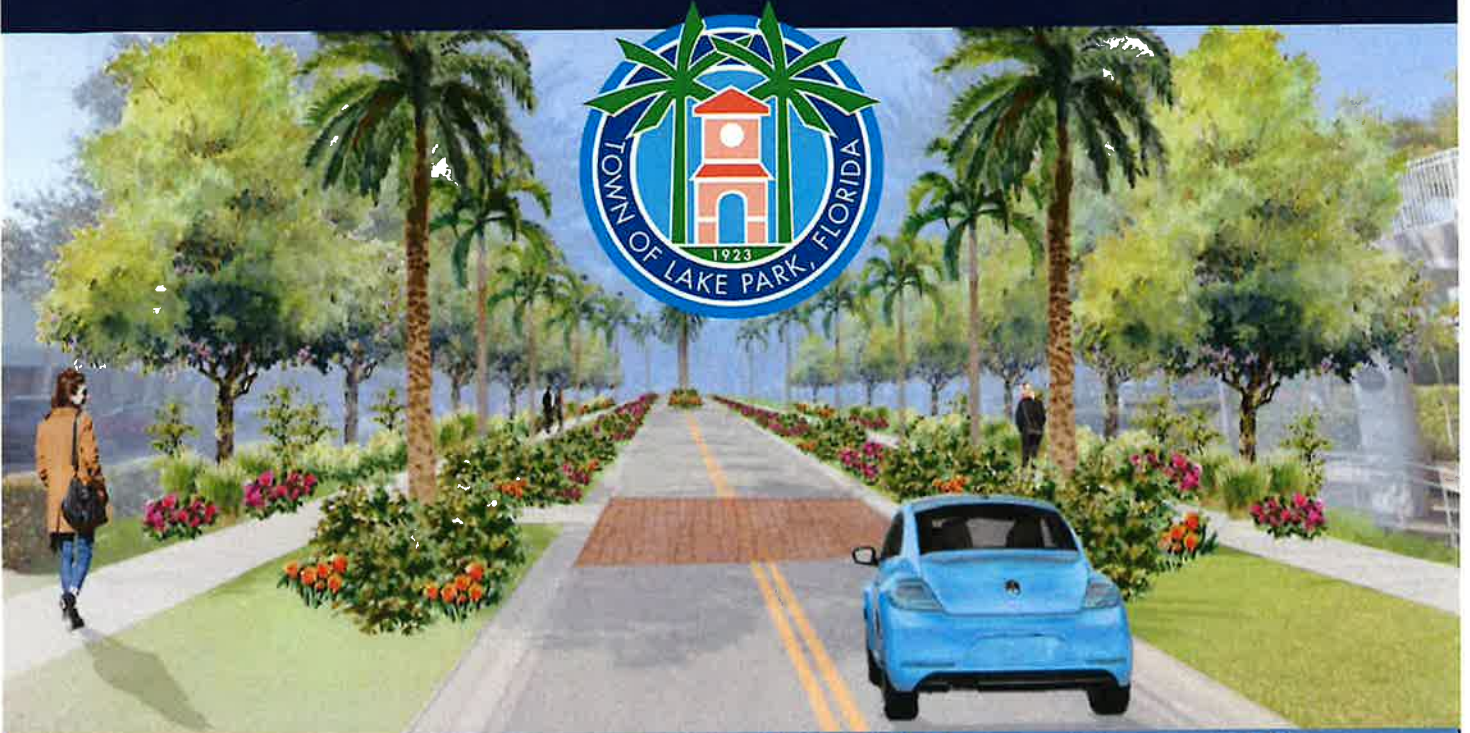

## **WHAT**

## **PUBLIC WORKSHOP**

The Town of Lake Park is interested in implementing a new design for the landscape/streetscape of Park Avenue and 10th Street. We would like to obtain input from the general public and other stakeholders regarding the design options.

## **WHERE**

## **TOWN HALL**

Commission Chambers  
535 Park Avenue  
Lake Park, FL 33403

## **WHEN**

## **MONDAY**

January 24, 2022  
6:30 PM - 8:00 PM



For more information please contact the Public Works Department at 561-881-3345 or [publicworks@lakeparkflorida.gov](mailto:publicworks@lakeparkflorida.gov)

## PUBLIC WORKSHOP

01/24/2022

NAME	EMAIL ADDRESS
JOHN WILLE	jwille@lakeparkflorida.gov
Dwayne Bell	dbell@lakeparkflorida.gov
Christoph Orma	cobner1947@yahoo.com
ROBERTO TRAVIESO	RTTRAVIESO@LAKEPARKFLORIDA.GOV
Sue Duchene	s.duchene@att.net
Cindy Kelsey	cmkelsey1@yahoo.com
Jon Buechele	Jonmonerie@hotmail.com
John D'Agostino	JDAgostino@lakeparkflorida.gov
Patricia Ledue	patricialedue@comcast.net
Dr. Stacy-Ann Smith	abundantchiropractic@gmail.com
Jackie Dudkiewicz	ModelingSchool@aol.com
✓ Mary Taylor	m.b.popp@hotmail.com
GILLIAM KENNEDY WRIGHT	WRIGHT WRIGHT@AOL.COM
Lou Ledue	louledue@comcast.net
Farrell Tiller	Farrelltiller@yahoo.com
Brady Drew	bradypdrew@gmail.com

Lizzy Woolford MS.WoolfordKinder@gmail.com

Ryan Keany ryan.keany@gmail.com.

E H Clark ehclarkbar@aol.com

Ritchie McHam rmcham88@gmail.com

# PROPOSED STREET-SCAPE ENHANCEMENTS

Park Avenue (from 7<sup>th</sup> to 10<sup>th</sup> Street North)

10<sup>th</sup> Street (from Park Avenue to Northern Drive)

## DESCRIPTION OF ENHANCEMENT

## LEVEL OF INTEREST

### Safety Improvements and Hardscape Enhancements:

- 1) REPLACE CONCRETE SIDEWALKS WITH DECORATIVE PAVERS
- 2) UP-GRADE BUS STOP AREAS W/ TRASH CANS / PLANT POTTERY / PERGOLAS
- 3) ADD PAVER ACCENTS TO INTERSECTIONS ALONG 10<sup>TH</sup> STREET
- 4) ADD PAVER PEDESTRIAN CROSSWALK AT LOCATIONS ON 10TH STREET
- 5) ADD DECORATIVE LIGHT POLES ALONG 10<sup>TH</sup> STREET (To Match Park Avenue)

Very High    Some What    Neutral    Very Low    None

<input checked="" type="checkbox"/>	<input type="checkbox"/>	<input type="checkbox"/>	<input type="checkbox"/>	<input type="checkbox"/>
<input checked="" type="checkbox"/>	<input type="checkbox"/>	<input type="checkbox"/>	<input type="checkbox"/>	<input type="checkbox"/>
<input checked="" type="checkbox"/>	<input type="checkbox"/>	<input type="checkbox"/>	<input type="checkbox"/>	<input type="checkbox"/>
<input checked="" type="checkbox"/>	<input type="checkbox"/>	<input type="checkbox"/>	<input type="checkbox"/>	<input type="checkbox"/>
<input checked="" type="checkbox"/>	<input type="checkbox"/>	<input type="checkbox"/>	<input type="checkbox"/>	<input type="checkbox"/>

### Landscape Improvements:

- 6) ADD STREET-SIDE COLORFUL PLANT & FLOWER GROUND COVER
- 7) ADD ACCENT PLANT GROUND COVER AT STREET LANDSCAPE ISLANDS
- 8) ENHANCE TREES ALONG 10<sup>TH</sup> AVENUE ( New Understory Trees and Palms)
- 9) ENHANCE BUS STOP AREAS BY ADDING POTTERY AND/OR PERGOLAS

Very High    Some What    Neutral    Very Low    None

<input checked="" type="checkbox"/>	<input type="checkbox"/>	<input type="checkbox"/>	<input type="checkbox"/>	<input type="checkbox"/>
<input checked="" type="checkbox"/>	<input type="checkbox"/>	<input type="checkbox"/>	<input type="checkbox"/>	<input type="checkbox"/>
<input checked="" type="checkbox"/>	<input type="checkbox"/>	<input type="checkbox"/>	<input type="checkbox"/>	<input type="checkbox"/>
<input checked="" type="checkbox"/>	<input type="checkbox"/>	<input type="checkbox"/>	<input type="checkbox"/>	<input type="checkbox"/>

### Other Comments:

*Statement Park/10th*      *Companies sponsor trees with art*      *Flowering Trees*      *Companies sponsor art P.2*

- ① art in the planning / zoning application
- ② Companies to sponsor trees
- ③ Trees / landscape to make a statement



# PROPOSED STREET-SCAPE ENHANCEMENTS

Park Avenue (from 7<sup>th</sup> to 10<sup>th</sup> Street North)

10<sup>th</sup> Street (from Park Avenue to Northern Drive)

## DESCRIPTION OF ENHANCEMENT

## LEVEL OF INTEREST

### Safety Improvements and Hardscape Enhancements:

- 1) REPLACE CONCRETE SIDEWALKS WITH DECORATIVE PAVERS
- 2) UP-GRADE BUS STOP AREAS W/ TRASH CANS / PLANT POTTERY / PERGOLAS
- 3) ADD PAVER ACCENTS TO INTERSECTIONS ALONG 10<sup>TH</sup> STREET
- 4) ADD PAVER PEDESTRIAN CROSSWALK AT LOCATIONS ON 10TH STREET
- 5) ADD DECORATIVE LIGHT POLES ALONG 10<sup>TH</sup> STREET (To Match Park Avenue)

Very High    Some What    Neutral    Very Low    None

<input checked="" type="checkbox"/>	<input type="checkbox"/>	<input type="checkbox"/>	<input type="checkbox"/>	<input type="checkbox"/>
<input checked="" type="checkbox"/>	<input type="checkbox"/>	<input type="checkbox"/>	<input type="checkbox"/>	<input type="checkbox"/>
<input checked="" type="checkbox"/>	<input type="checkbox"/>	<input type="checkbox"/>	<input type="checkbox"/>	<input type="checkbox"/>
<input checked="" type="checkbox"/>	<input type="checkbox"/>	<input type="checkbox"/>	<input type="checkbox"/>	<input type="checkbox"/>
<input checked="" type="checkbox"/>	<input type="checkbox"/>	<input type="checkbox"/>	<input type="checkbox"/>	<input type="checkbox"/>

### Landscape Improvements:

- 6) ADD STREET-SIDE COLORFUL PLANT & FLOWER GROUND COVER
- 7) ADD ACCENT PLANT GROUND COVER AT STREET LANDSCAPE ISLANDS
- 8) ENHANCE TREES ALONG 10<sup>TH</sup> AVENUE ( New Understory Trees and Palms)
- 9) ENHANCE BUS STOP AREAS BY ADDING POTTERY AND/OR PERGOLAS

Very High    Some What    Neutral    Very Low    None

<input checked="" type="checkbox"/>	<input type="checkbox"/>	<input type="checkbox"/>	<input type="checkbox"/>	<input type="checkbox"/>
<input checked="" type="checkbox"/>	<input type="checkbox"/>	<input type="checkbox"/>	<input type="checkbox"/>	<input type="checkbox"/>
<input checked="" type="checkbox"/>	<input type="checkbox"/>	<input type="checkbox"/>	<input type="checkbox"/>	<input type="checkbox"/>
<input checked="" type="checkbox"/>	<input type="checkbox"/>	<input type="checkbox"/>	<input type="checkbox"/>	<input type="checkbox"/>

### Other Comments:

Cycling (markings or bike lanes), canopy trees and native plants are preferred over palms, art

# PROPOSED STREET-SCAPE ENHANCEMENTS

Park Avenue (from 7<sup>th</sup> to 10<sup>th</sup> Street North)

10<sup>th</sup> Street (from Park Avenue to Northern Drive)

## DESCRIPTION OF ENHANCEMENT

## LEVEL OF INTEREST

### Safety Improvements and Hardscape Enhancements:

- 1) REPLACE CONCRETE SIDEWALKS WITH DECORATIVE PAVERS
- 2) UP-GRADE BUS STOP AREAS W/ TRASH CANS / PLANT POTTERY / PERGOLAS
- 3) ADD PAVER ACCENTS TO INTERSECTIONS ALONG 10<sup>TH</sup> STREET
- 4) ADD PAVER PEDESTRIAN CROSSWALK AT LOCATIONS ON 10TH STREET
- 5) ADD DECORATIVE LIGHT POLES ALONG 10<sup>TH</sup> STREET (To Match Park Avenue)

Very High	Some What	Neutral	Very Low	None
<input checked="" type="checkbox"/>	<input type="checkbox"/>	<input type="checkbox"/>	<input type="checkbox"/>	<input type="checkbox"/>
<input type="checkbox"/>	<input checked="" type="checkbox"/>	<input type="checkbox"/>	<input type="checkbox"/>	<input type="checkbox"/>
<input checked="" type="checkbox"/>	<input type="checkbox"/>	<input type="checkbox"/>	<input type="checkbox"/>	<input type="checkbox"/>
<input checked="" type="checkbox"/>	<input type="checkbox"/>	<input type="checkbox"/>	<input type="checkbox"/>	<input type="checkbox"/>
<input checked="" type="checkbox"/>	<input type="checkbox"/>	<input type="checkbox"/>	<input type="checkbox"/>	<input type="checkbox"/>

### Landscape Improvements:

- 6) ADD STREET-SIDE COLORFUL PLANT & FLOWER GROUND COVER
- 7) ADD ACCENT PLANT GROUND COVER AT STREET LANDSCAPE ISLANDS
- 8) ENHANCE TREES ALONG 10<sup>TH</sup> AVENUE ( New Understory Trees and Palms)
- 9) ENHANCE BUS STOP AREAS BY ADDING POTTERY AND/OR PERGOLAS

Very High	Some What	Neutral	Very Low	None
<input type="checkbox"/>	<input type="checkbox"/>	<input type="checkbox"/>	<input type="checkbox"/>	<input type="checkbox"/>
<input checked="" type="checkbox"/>	<input type="checkbox"/>	<input type="checkbox"/>	<input type="checkbox"/>	<input type="checkbox"/>
<input checked="" type="checkbox"/>	<input type="checkbox"/>	<input type="checkbox"/>	<input type="checkbox"/>	<input type="checkbox"/>
<input type="checkbox"/>	<input checked="" type="checkbox"/>	<input type="checkbox"/>	<input type="checkbox"/>	<input type="checkbox"/>

### Other Comments:

Bike Lanes? Concerned with the length of the project. ART / Sculptures /

---



---



---



---

# PROPOSED STREET-SCAPE ENHANCEMENTS

Park Avenue (from 7<sup>th</sup> to 10<sup>th</sup> Street North)

10<sup>th</sup> Street (from Park Avenue to Northern Drive)

## DESCRIPTION OF ENHANCEMENT

## LEVEL OF INTEREST

### Safety Improvements and Hardscape Enhancements:

	Very High	Some What	Neutral	Very Low	None
1) REPLACE CONCRETE SIDEWALKS WITH DECORATIVE PAVERS	<input type="checkbox"/>	<input type="checkbox"/>	<input type="checkbox"/>	<input checked="" type="checkbox"/>	<input type="checkbox"/>
2) UP-GRADE BUS STOP AREAS W/ TRASH CANS / PLANT POTTERY / PERGOLAS	<input checked="" type="checkbox"/>	<input type="checkbox"/>	<input type="checkbox"/>	<input type="checkbox"/>	<input type="checkbox"/>
3) ADD PAVER ACCENTS TO INTERSECTIONS ALONG 10 <sup>TH</sup> STREET	<input type="checkbox"/>	<input type="checkbox"/>	<input checked="" type="checkbox"/>	<input type="checkbox"/>	<input type="checkbox"/>
4) ADD PAVER PEDESTRIAN CROSSWALK AT LOCATIONS ON 10TH STREET	<input type="checkbox"/>	<input checked="" type="checkbox"/>	<input type="checkbox"/>	<input type="checkbox"/>	<input type="checkbox"/>
5) ADD DECORATIVE LIGHT POLES ALONG 10 <sup>TH</sup> STREET (To Match Park Avenue)	<input type="checkbox"/>	<input checked="" type="checkbox"/>	<input type="checkbox"/>	<input type="checkbox"/>	<input type="checkbox"/>

### Landscape Improvements:

	Very High	Some What	Neutral	Very Low	None
6) ADD STREET-SIDE COLORFUL PLANT & FLOWER GROUND COVER	<input type="checkbox"/>	<input checked="" type="checkbox"/>	<input type="checkbox"/>	<input type="checkbox"/>	<input type="checkbox"/>
7) ADD ACCENT PLANT GROUND COVER AT STREET LANDSCAPE ISLANDS	<input type="checkbox"/>	<input checked="" type="checkbox"/>	<input type="checkbox"/>	<input type="checkbox"/>	<input type="checkbox"/>
8) ENHANCE TREES ALONG 10 <sup>TH</sup> AVENUE ( New Understory Trees and Palms)	<input checked="" type="checkbox"/>	<input type="checkbox"/>	<input type="checkbox"/>	<input type="checkbox"/>	<input type="checkbox"/>
9) ENHANCE BUS STOP AREAS BY ADDING POTTERY AND/OR PERGOLAS	<input checked="" type="checkbox"/>	<input type="checkbox"/>	<input type="checkbox"/>	<input type="checkbox"/>	<input type="checkbox"/>

### Other Comments:

*Excellent ideas, but how does this enhance safety & security overall for Town residents?  
Love ideas for bus stop benches & decor, but fear it may attract predatory characters.*

# PROPOSED STREET-SCAPE ENHANCEMENTS

Park Avenue (from 7<sup>th</sup> to 10<sup>th</sup> Street North)

10<sup>th</sup> Street (from Park Avenue to Northern Drive)

## DESCRIPTION OF ENHANCEMENT

## LEVEL OF INTEREST

### Safety Improvements and Hardscape Enhancements:

	Very High	Some What	Neutral	Very Low	None
1) REPLACE CONCRETE SIDEWALKS WITH DECORATIVE PAVERS	<input type="checkbox"/>	<input type="checkbox"/>	<input type="checkbox"/>	<input checked="" type="checkbox"/>	<input type="checkbox"/>
2) UP-GRADE BUS STOP AREAS W/ TRASH CANS / PLANT POTTERY / PERGOLAS	<input checked="" type="checkbox"/>	<input type="checkbox"/>	<input type="checkbox"/>	<input type="checkbox"/>	<input type="checkbox"/>
3) ADD PAVER ACCENTS TO INTERSECTIONS ALONG 10 <sup>TH</sup> STREET	<input checked="" type="checkbox"/>	<input type="checkbox"/>	<input type="checkbox"/>	<input type="checkbox"/>	<input type="checkbox"/>
4) ADD PAVER PEDESTRIAN CROSSWALK AT LOCATIONS ON 10TH STREET	<input checked="" type="checkbox"/>	<input type="checkbox"/>	<input type="checkbox"/>	<input type="checkbox"/>	<input type="checkbox"/>
5) ADD DECORATIVE LIGHT POLES ALONG 10 <sup>TH</sup> STREET (To Match Park Avenue)	<input type="checkbox"/>	<input checked="" type="checkbox"/>	<input type="checkbox"/>	<input type="checkbox"/>	<input type="checkbox"/>

### Landscape Improvements:

	Very High	Some What	Neutral	Very Low	None
6) ADD STREET-SIDE COLORFUL PLANT & FLOWER GROUND COVER	<input checked="" type="checkbox"/>	<input type="checkbox"/>	<input type="checkbox"/>	<input type="checkbox"/>	<input type="checkbox"/>
7) ADD ACCENT PLANT GROUND COVER AT STREET LANDSCAPE ISLANDS	<input checked="" type="checkbox"/>	<input type="checkbox"/>	<input type="checkbox"/>	<input type="checkbox"/>	<input type="checkbox"/>
8) ENHANCE TREES ALONG 10 <sup>TH</sup> AVENUE ( New Understory Trees and Palms)	<input type="checkbox"/>	<input checked="" type="checkbox"/>	<input type="checkbox"/>	<input type="checkbox"/>	<input type="checkbox"/>
9) ENHANCE BUS STOP AREAS BY ADDING POTTERY AND/OR PERGOLAS	<input checked="" type="checkbox"/>	<input type="checkbox"/>	<input type="checkbox"/>	<input type="checkbox"/>	<input type="checkbox"/>

### Other Comments:

I do not support pavers on sidewalks, That would create a big expense. That money can be used better in intersections. 10<sup>th</sup> Street is in dire need of an overhaul. The intersection at Park and 10<sup>th</sup> needs special attention.

# PROPOSED STREET-SCAPE ENHANCEMENTS

Park Avenue (from 7<sup>th</sup> to 10<sup>th</sup> Street North)

10<sup>th</sup> Street (from Park Avenue to Northern Drive)

## DESCRIPTION OF ENHANCEMENT

## LEVEL OF INTEREST

### Safety Improvements and Hardscape Enhancements:

- 1) REPLACE CONCRETE SIDEWALKS WITH DECORATIVE PAVERS
- 2) UP-GRADE BUS STOP AREAS W/ TRASH CANS / PLANT POTTERY / PERGOLAS
- 3) ADD PAVER ACCENTS TO INTERSECTIONS ALONG 10<sup>TH</sup> STREET
- 4) ADD PAVER PEDESTRIAN CROSSWALK AT LOCATIONS ON 10TH STREET
- 5) ADD DECORATIVE LIGHT POLES ALONG 10<sup>TH</sup> STREET (To Match Park Avenue)

Very High    Some What    Neutral    Very Low    None

<input checked="" type="checkbox"/>	<input type="checkbox"/>	<input type="checkbox"/>	<input type="checkbox"/>	<input type="checkbox"/>
<input checked="" type="checkbox"/>	<input type="checkbox"/>	<input type="checkbox"/>	<input type="checkbox"/>	<input type="checkbox"/>
<input type="checkbox"/>	<input checked="" type="checkbox"/>	<input type="checkbox"/>	<input type="checkbox"/>	<input type="checkbox"/>
<input checked="" type="checkbox"/>	<input type="checkbox"/>	<input type="checkbox"/>	<input type="checkbox"/>	<input type="checkbox"/>
<input checked="" type="checkbox"/>	<input type="checkbox"/>	<input type="checkbox"/>	<input type="checkbox"/>	<input type="checkbox"/>

### Landscape Improvements:

- 6) ADD STREET-SIDE COLORFUL PLANT & FLOWER GROUND COVER
- 7) ADD ACCENT PLANT GROUND COVER AT STREET LANDSCAPE ISLANDS
- 8) ENHANCE TREES ALONG 10<sup>TH</sup> AVENUE ( New Understory Trees and Palms)
- 9) ENHANCE BUS STOP AREAS BY ADDING POTTERY AND/OR PERGOLAS

Very High    Some What    Neutral    Very Low    None

<input checked="" type="checkbox"/>	<input type="checkbox"/>	<input type="checkbox"/>	<input type="checkbox"/>	<input type="checkbox"/>
<input checked="" type="checkbox"/>	<input type="checkbox"/>	<input type="checkbox"/>	<input type="checkbox"/>	<input type="checkbox"/>
<input checked="" type="checkbox"/>	<input type="checkbox"/>	<input type="checkbox"/>	<input type="checkbox"/>	<input type="checkbox"/>
<input checked="" type="checkbox"/>	<input type="checkbox"/>	<input type="checkbox"/>	<input type="checkbox"/>	<input type="checkbox"/>

### Other Comments:

Native plants in common areas, Sponsorship from Business/Residence for Trees  
paver areas

# PROPOSED STREET-SCAPE ENHANCEMENTS

Park Avenue (from 7<sup>th</sup> to 10<sup>th</sup> Street North)

10<sup>th</sup> Street (from Park Avenue to Northern Drive)

## DESCRIPTION OF ENHANCEMENT

## LEVEL OF INTEREST

### Safety Improvements and Hardscape Enhancements:

- 1) REPLACE CONCRETE SIDEWALKS WITH DECORATIVE PAVERS
- 2) UP-GRADE BUS STOP AREAS W/ TRASH CANS / PLANT POTTERY / PERGOLAS
- 3) ADD PAVER ACCENTS TO INTERSECTIONS ALONG 10<sup>TH</sup> STREET
- 4) ADD PAVER PEDESTRIAN CROSSWALK AT LOCATIONS ON 10TH STREET
- 5) ADD DECORATIVE LIGHT POLES ALONG 10<sup>TH</sup> STREET (To Match Park Avenue)

Very High	Some What	Neutral	Very Low	None
<input type="checkbox"/>	<input checked="" type="checkbox"/>	<input type="checkbox"/>	<input type="checkbox"/>	<input type="checkbox"/>
<input checked="" type="checkbox"/>	<input type="checkbox"/>	<input type="checkbox"/>	<input type="checkbox"/>	<input type="checkbox"/>
<input checked="" type="checkbox"/>	<input type="checkbox"/>	<input type="checkbox"/>	<input type="checkbox"/>	<input type="checkbox"/>
<input checked="" type="checkbox"/>	<input type="checkbox"/>	<input type="checkbox"/>	<input type="checkbox"/>	<input type="checkbox"/>
<input checked="" type="checkbox"/>	<input type="checkbox"/>	<input type="checkbox"/>	<input type="checkbox"/>	<input type="checkbox"/>

### Landscape Improvements:

- 6) ADD STREET-SIDE COLORFUL PLANT & FLOWER GROUND COVER
- 7) ADD ACCENT PLANT GROUND COVER AT STREET LANDSCAPE ISLANDS
- 8) ENHANCE TREES ALONG 10<sup>TH</sup> AVENUE ( New Understory Trees and Palms)
- 9) ENHANCE BUS STOP AREAS BY ADDING POTTERY AND/OR PERGOLAS

Very High	Some What	Neutral	Very Low	None
<input type="checkbox"/>	<input checked="" type="checkbox"/>	<input type="checkbox"/>	<input type="checkbox"/>	<input type="checkbox"/>
<input type="checkbox"/>	<input checked="" type="checkbox"/>	<input type="checkbox"/>	<input type="checkbox"/>	<input type="checkbox"/>
<input checked="" type="checkbox"/>	<input type="checkbox"/>	<input type="checkbox"/>	<input type="checkbox"/>	<input type="checkbox"/>
<input checked="" type="checkbox"/>	<input type="checkbox"/>	<input type="checkbox"/>	<input type="checkbox"/>	<input type="checkbox"/>

### Other Comments:

---



---



---



---



---

# PROPOSED STREET-SCAPE ENHANCEMENTS

Park Avenue (from 7<sup>th</sup> to 10<sup>th</sup> Street North)

10<sup>th</sup> Street (from Park Avenue to Northern Drive)

## DESCRIPTION OF ENHANCEMENT

## LEVEL OF INTEREST

### Safety Improvements and Hardscape Enhancements:

- 1) REPLACE CONCRETE SIDEWALKS WITH DECORATIVE PAVERS
- 2) UP-GRADE BUS STOP AREAS W/ TRASH CANS / PLANT POTTERY / PERGOLAS
- 3) ADD PAVER ACCENTS TO INTERSECTIONS ALONG 10<sup>TH</sup> STREET
- 4) ADD PAVER PEDESTRIAN CROSSWALK AT LOCATIONS ON 10TH STREET
- 5) ADD DECORATIVE LIGHT POLES ALONG 10<sup>TH</sup> STREET (To Match Park Avenue)

Very High    Some What    Neutral    Very Low    None

<input checked="" type="checkbox"/>	<input type="checkbox"/>	<input type="checkbox"/>	<input type="checkbox"/>	<input type="checkbox"/>
<input checked="" type="checkbox"/>	<input type="checkbox"/>	<input type="checkbox"/>	<input type="checkbox"/>	<input type="checkbox"/>
<input checked="" type="checkbox"/>	<input type="checkbox"/>	<input type="checkbox"/>	<input type="checkbox"/>	<input type="checkbox"/>
<input checked="" type="checkbox"/>	<input type="checkbox"/>	<input type="checkbox"/>	<input type="checkbox"/>	<input type="checkbox"/>
<input checked="" type="checkbox"/>	<input type="checkbox"/>	<input type="checkbox"/>	<input type="checkbox"/>	<input type="checkbox"/>

### Landscape Improvements:

- 6) ADD STREET-SIDE COLORFUL PLANT & FLOWER GROUND COVER
- 7) ADD ACCENT PLANT GROUND COVER AT STREET LANDSCAPE ISLANDS
- 8) ENHANCE TREES ALONG 10<sup>TH</sup> AVENUE ( New Understory Trees and Palms)
- 9) ENHANCE BUS STOP AREAS BY ADDING POTTERY AND/OR PERGOLAS

Very High    Some What    Neutral    Very Low    None

<input checked="" type="checkbox"/>	<input type="checkbox"/>	<input type="checkbox"/>	<input type="checkbox"/>	<input type="checkbox"/>
<input checked="" type="checkbox"/>	<input type="checkbox"/>	<input type="checkbox"/>	<input type="checkbox"/>	<input type="checkbox"/>
<input checked="" type="checkbox"/>	<input type="checkbox"/>	<input type="checkbox"/>	<input type="checkbox"/>	<input type="checkbox"/>
<input type="checkbox"/>	<input type="checkbox"/>	<input type="checkbox"/>	<input type="checkbox"/>	<input type="checkbox"/>

### Other Comments:

- ① Important to use native plant palette
- ② water drainage
- ③ Sustainable plant pottery? ..
- ④ Will there be any public art?

# PROPOSED STREET-SCAPE ENHANCEMENTS

**Park Avenue (from 7<sup>th</sup> to 10<sup>th</sup> Street North)**

**10<sup>th</sup> Street (from Park Avenue to Northern Drive)**

## DESCRIPTION OF ENHANCEMENT

## LEVEL OF INTEREST

### Safety Improvements and Hardscape Enhancements:

- 1) REPLACE CONCRETE SIDEWALKS WITH DECORATIVE PAVERS
- 2) UP-GRADE BUS STOP AREAS W/ TRASH CANS / PLANT POTTERY / PERGOLAS
- 3) ADD PAVER ACCENTS TO INTERSECTIONS ALONG 10<sup>TH</sup> STREET
- 4) ADD PAVER PEDESTRIAN CROSSWALK AT LOCATIONS ON 10TH STREET
- 5) ADD DECORATIVE LIGHT POLES ALONG 10<sup>TH</sup> STREET (To Match Park Avenue)

Very High	Some What	Neutral	Very Low	None
<input checked="" type="checkbox"/>	<input type="checkbox"/>	<input type="checkbox"/>	<input type="checkbox"/>	<input type="checkbox"/>
<input type="checkbox"/>	<input checked="" type="checkbox"/>	<input type="checkbox"/>	<input type="checkbox"/>	<input type="checkbox"/>
<input checked="" type="checkbox"/>	<input type="checkbox"/>	<input type="checkbox"/>	<input type="checkbox"/>	<input type="checkbox"/>
<input checked="" type="checkbox"/>	<input type="checkbox"/>	<input type="checkbox"/>	<input type="checkbox"/>	<input type="checkbox"/>
<input checked="" type="checkbox"/>	<input type="checkbox"/>	<input type="checkbox"/>	<input type="checkbox"/>	<input type="checkbox"/>

### Landscape Improvements:

- 6) ADD STREET-SIDE COLORFUL PLANT & FLOWER GROUND COVER
- 7) ADD ACCENT PLANT GROUND COVER AT STREET LANDSCAPE ISLANDS
- 8) ENHANCE TREES ALONG 10<sup>TH</sup> AVENUE ( New Understory Trees and Palms)
- 9) ENHANCE BUS STOP AREAS BY ADDING POTTERY AND/OR PERGOLAS

Very High	Some What	Neutral	Very Low	None
<input checked="" type="checkbox"/>	<input type="checkbox"/>	<input type="checkbox"/>	<input type="checkbox"/>	<input type="checkbox"/>
<input checked="" type="checkbox"/>	<input type="checkbox"/>	<input type="checkbox"/>	<input type="checkbox"/>	<input type="checkbox"/>
<input checked="" type="checkbox"/>	<input type="checkbox"/>	<input type="checkbox"/>	<input type="checkbox"/>	<input type="checkbox"/>
<input type="checkbox"/>	<input checked="" type="checkbox"/>	<input type="checkbox"/>	<input type="checkbox"/>	<input type="checkbox"/>

### Other Comments:

---



---



---



---



---



# PROPOSED STREET-SCAPE ENHANCEMENTS

Park Avenue (from 7<sup>th</sup> to 10<sup>th</sup> Street North)

10<sup>th</sup> Street (from Park Avenue to Northern Drive)

## DESCRIPTION OF ENHANCEMENT

## LEVEL OF INTEREST

### Safety Improvements and Hardscape Enhancements:

- 1) REPLACE CONCRETE SIDEWALKS WITH DECORATIVE PAVERS
- 2) UP-GRADE BUS STOP AREAS W/ TRASH CANS / PLANT POTTERY / PERGOLAS
- 3) ADD PAVER ACCENTS TO INTERSECTIONS ALONG 10<sup>TH</sup> STREET
- 4) ADD PAVER PEDESTRIAN CROSSWALK AT LOCATIONS ON 10TH STREET
- 5) ADD DECORATIVE LIGHT POLES ALONG 10<sup>TH</sup> STREET (To Match Park Avenue)

Very High	Some What	Neutral	Very Low	None
<input checked="" type="checkbox"/>	<input checked="" type="checkbox"/>	<input type="checkbox"/>	<input type="checkbox"/>	<input type="checkbox"/>
<input checked="" type="checkbox"/>	<input checked="" type="checkbox"/>	<input type="checkbox"/>	<input type="checkbox"/>	<input type="checkbox"/>
<input checked="" type="checkbox"/>	<input checked="" type="checkbox"/>	<input type="checkbox"/>	<input type="checkbox"/>	<input type="checkbox"/>
<input checked="" type="checkbox"/>	<input checked="" type="checkbox"/>	<input type="checkbox"/>	<input type="checkbox"/>	<input type="checkbox"/>
<input checked="" type="checkbox"/>	<input type="checkbox"/>	<input type="checkbox"/>	<input type="checkbox"/>	<input type="checkbox"/>

### Landscape Improvements:

- 6) ADD STREET-SIDE COLORFUL PLANT & FLOWER GROUND COVER
- 7) ADD ACCENT PLANT GROUND COVER AT STREET LANDSCAPE ISLANDS
- 8) ENHANCE TREES ALONG 10<sup>TH</sup> AVENUE ( New Understory Trees and Palms)
- 9) ENHANCE BUS STOP AREAS BY ADDING POTTERY AND/OR PERGOLAS

Very High	Some What	Neutral	Very Low	None
<input checked="" type="checkbox"/>	<input checked="" type="checkbox"/>	<input type="checkbox"/>	<input type="checkbox"/>	<input type="checkbox"/>
<input checked="" type="checkbox"/>	<input checked="" type="checkbox"/>	<input type="checkbox"/>	<input type="checkbox"/>	<input type="checkbox"/>
<input checked="" type="checkbox"/>	<input type="checkbox"/>	<input type="checkbox"/>	<input type="checkbox"/>	<input type="checkbox"/>
<input checked="" type="checkbox"/>	<input type="checkbox"/>	<input type="checkbox"/>	<input type="checkbox"/>	<input type="checkbox"/>

### Other Comments:

→ Safety (?) Making sure ppl. do not vandalize or live in pergola  
I suggest you continue Park Avenue enhancements all the way to US Highway 1. but I understand that is not in the CRA.  
I am all about making things more efficient, safer and prettier!  
Thank you!

# PROPOSED STREET-SCAPE ENHANCEMENTS

Park Avenue (from 7<sup>th</sup> to 10<sup>th</sup> Street North)

10<sup>th</sup> Street (from Park Avenue to Northern Drive)

## DESCRIPTION OF ENHANCEMENT

## LEVEL OF INTEREST

### Safety Improvements and Hardscape Enhancements:

	Very High	Some What	Neutral	Very Low	None
1) REPLACE CONCRETE SIDEWALKS WITH DECORATIVE PAVERS	<input checked="" type="checkbox"/>	<input type="checkbox"/>	<input type="checkbox"/>	<input type="checkbox"/>	<input type="checkbox"/>
2) UP-GRADE BUS STOP AREAS W/ TRASH CANS / PLANT POTTERY / PERGOLAS	<input checked="" type="checkbox"/>	<input type="checkbox"/>	<input type="checkbox"/>	<input type="checkbox"/>	<input type="checkbox"/>
3) ADD PAVER ACCENTS TO INTERSECTIONS ALONG 10 <sup>TH</sup> STREET	<input checked="" type="checkbox"/>	<input type="checkbox"/>	<input type="checkbox"/>	<input type="checkbox"/>	<input type="checkbox"/>
4) ADD PAVER PEDESTRIAN CROSSWALK AT LOCATIONS ON 10TH STREET	<input checked="" type="checkbox"/>	<input type="checkbox"/>	<input type="checkbox"/>	<input type="checkbox"/>	<input type="checkbox"/>
5) ADD DECORATIVE LIGHT POLES ALONG 10 <sup>TH</sup> STREET (To Match Park Avenue)	<input checked="" type="checkbox"/>	<input type="checkbox"/>	<input type="checkbox"/>	<input type="checkbox"/>	<input type="checkbox"/>

### Landscape Improvements:

	Very High	Some What	Neutral	Very Low	None
6) ADD STREET-SIDE COLORFUL PLANT & FLOWER GROUND COVER	<input checked="" type="checkbox"/>	<input type="checkbox"/>	<input type="checkbox"/>	<input type="checkbox"/>	<input type="checkbox"/>
7) ADD ACCENT PLANT GROUND COVER AT STREET LANDSCAPE ISLANDS	<input checked="" type="checkbox"/>	<input type="checkbox"/>	<input type="checkbox"/>	<input type="checkbox"/>	<input type="checkbox"/>
8) ENHANCE TREES ALONG 10 <sup>TH</sup> AVENUE ( New Understory Trees and Palms)	<input checked="" type="checkbox"/>	<input type="checkbox"/>	<input type="checkbox"/>	<input type="checkbox"/>	<input type="checkbox"/>
9) ENHANCE BUS STOP AREAS BY ADDING POTTERY AND/OR PERGOLAS	<input checked="" type="checkbox"/>	<input type="checkbox"/>	<input type="checkbox"/>	<input type="checkbox"/>	<input type="checkbox"/>

### Other Comments:

An overhead shelter for the bus stop at 800 Park Stop would be a nice necessary addition.

Trees besides Palms to add diversity.

Color added in Landscape islands.